

■ STEEL PIPE NIPPLE WITH AMERICAN STANDARD

AMERICAN STANDARD: ASTM A733
 PIPE: ASTM A53/ASTM A106/ASTM A333
 THREADS: ANSI B1.20.1
 SCH: 40.80.160.XXS



■ STEEL PIPE NIPPLE WITH BRITISH/DIN STANDARD

BRITISH STANDARD: BS EN10241
 PIPE: BS1387,Medium&Heavy
 THREADS: ISO7/1
DIN STANDARD: DIN 2982
 PIPE: DIN 2440,Medium&Heavy
 THREADS: DIN 2999



Note: Heavy-type as per above sheet

Type of Nipple	1/8	1/4	3/8	1/2	3/4	1	1 1/4	1 1/2	2	2 1/2	3	3 1/2	4	5	6	8
CLOSE	3/4	7/8	1	1 1/8	1 3/8	1 1/2	1 5/8	1 3/4	2	2 1/2	2 5/8	2 3/4	2 7/8	3	3 1/8	3 1/2
Short and long type	1 1/2	1 1/2	1 1/2	1 1/2	1 1/2
	2	2	2	2	2	2	2	2
	2 1/2	2 1/2	2 1/2	2 1/2	2 1/2	2 1/2	2 1/2	2 1/2
	3	3	3	3	3	3	3	3	3	3	3
	3 1/2	3 1/2	3 1/2	3 1/2	3 1/2	3 1/2	3 1/2	3 1/2	3 1/2	3 1/2	3 1/2
	4	4	4	4	4	4	4	4	4	4	4	4	4
	4 1/2	4 1/2	4 1/2	4 1/2	4 1/2	4 1/2	4 1/2	4 1/2	4 1/2	4 1/2	4 1/2	4 1/2	4 1/2	4 1/2	4 1/2
	5	5	5	5	5	5	5	5	5	5	5	5	5	5	5	5
	5 1/2	5 1/2	5 1/2	5 1/2	5 1/2	5 1/2	5 1/2	5 1/2	5 1/2	5 1/2	5 1/2	5 1/2	5 1/2	5 1/2	5 1/2	5 1/2
	6	6	6	6	6	6	6	6	6	6	6	6	6	6	6	6
	7	7	7	7	7	7	7	7	7	7	7	7	7	7	7	7
	8	8	8	8	8	8	8	8	8	8	8	8	8	8	8	8
	9	9	9	9	9	9	9	9	9	9	9	9	9	9	9	9
	10	10	10	10	10	10	10	10	10	10	10	10	10	10	10	10
	11	11	11	11	11	11	11	11	11	11	11	11	11	11	11	11
	12	12	12	12	12	12	12	12	12	12	12	12	12	12	12	12
	13	13	13	13	13	13	13	13	13	13	13	13	13	13	13	13
	14	14	14	14	14	14	14	14	14	14	14	14	14	14	14	14
	15	15	15	15	15	15	15	15	15	15	15	15	15	15	15	15
	16	16	16	16	16	16	16	16	16	16	16	16	16	16	16	16
	17	17	17	17	17	17	17	17	17	17	17	17	17	17	17	17
	18	18	18	18	18	18	18	18	18	18	18	18	18	18	18	18
19	19	19	19	19	19	19	19	19	19	19	19	19	19	19	19	
20	20	20	20	20	20	20	20	20	20	20	20	20	20	20	20	
21	21	21	21	21	21	21	21	21	21	21	21	21	21	21	21	
22	22	22	22	22	22	22	22	22	22	22	22	22	22	22	22	
.....	

Size	6	8	10	15	20	25	32	40	50	65	80	100	125	150
CLOSE		27	28	37	39	46	51	51	60	69	75	87	96	96
Length	30	30	30											
	40	40	40	40	40									
	50	50	50	50	50	50	50	50						
	60	60	60	60	60	60	60	60	60					
	80	80	80	80	80	80	80	80	80	80	80			
	100	100	100	100	100	100	100	100	100	100	100	100		
	120	120	120	120	120	120	120	120	120	120	120	120	120	120
	150	150	150	150	150	150	150	150	150	150	150	150	150	150
	180	180	180	180	180	180	180	180	180	180	180	180	180	180
	200	200	200	200	200	200	200	200	200	200	200	200	200	200
	250	250	250	250	250	250	250	250	250	250	250	250	250	250
	300	300	300	300	300	300	300	300	300	300	300	300	300	300
												400	400	400
													500	500

STEEL PIPE NIPPLE

AMERICAN STANDARD STEEL MERCHANT COUPLING

AMERICAN STANDARD: ASTM A865

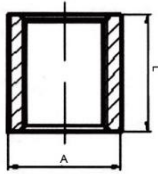

Size	1/8	1/4	3/8	1/2	3/4	1	1 1/4	1 1/2
Outside Diam	0.563	0.719	0.875	1.063	1.313	1.576	1.900	2.200
Length	3/4	1 1/8	1 1/8	1 1/2	1 9/16	1 15/16	2	2
Threads	NPSL	NPSL	NPSL	NPSL	NPSL	NPSL	NPSL	NPSL

Size	2	2 1/2	3	3 1/2	4	5	6
Outside Diam	2.750	3.250	4.000	4.625	5.000	6.296	7.390
Length	2 1/16	3 1/16	3 3/16	3 5/16	3 7/16	3 11/16	3 15/16
Threads	NPT	NPT	NPT	NPT	NPT	NPT	NPT

DIN STANDARD STEEL MERCHANT COUPLING

DIN STANDARD: DIN 2999



Size	6	8	10	15	20	25	32	
Standard	Min Outside Dia	15	18.5	21.3	26.6	31.8	39.5	48.3
	Length(mm)	17	25	26	34	36	43	48
Half	Min Outside Dia	15	18.5	21.3	26.6	31.8	39.5	48.3
	Length(mm)	8	11	12	15	17	20	22

BRITISH STANDARD STEEL MERCHANT COUPLING

BRITISH STANDARD: BS EN10241

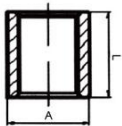

Size	8	10	15	20	25	32	40	50
Min. Outside Diam	18.5	22	27	32.5	39.5	49	56	68
Min Length	27	28	37	39	46	51	51	60

Size	65	80	100	125	150
Min. Outside Diam	84	98	124	151	178
Min Length	69	75	87	96	96

Size	40	50	65	80	100	125	150	
Standard	Min Outside Dia	54.5	66.2	82	95	121.4	146.3	173.3
	Length(mm)	48	56	65	71	83	92	92
Half	Min Outside Dia	54.5	68	84.2	98.4	124	149	177
	Length(mm)	22	26	30	34	40	44	44