

CONTENTS 目录

A 球阀系列 BALL VALVE

一片式球阀 1-PC BALL VALVE	1
二片式球阀 2-PC BALL VALVE	2-7
三片式球阀 3-PC BALL VALVE	8-11
三通球阀 3-WAY BALL VALVE	12
薄型球阀 WAFER BALL VALVE	13
产品形象图 IMAGE OF THE PRODUCT GRAPH	14
二片式法兰球阀 2-PC FLANGE BALL VALVE	15-16
美标法兰球阀 FLANGED BALL VALVE, ASME	17
德标法兰球阀 PAD FLANGED BALL VALVE, DIN	18
三片式法兰球阀 3-PC FLANGE BALL VALVE	19-20
国标法兰球阀 FLANGED BALL VALVE, GB/T	21

B 闸阀系列 GATE VALVE

丝扣闸阀 SCREW END GATE VALVE	22
美标法兰闸阀 FLANGE GATE VALVE, ASME	23-24
国标法兰闸阀 FLANGED GATE VALVE, GB/T	25-26

C 截止阀系列 GLOBE VALVE

丝扣截止阀 SCREW END GLOBE VALVE	27
美标法兰截止阀 FLANGE GLOBE VALVE, ASME	28-29
国标法兰截止阀 FLANGED GLOBE VALVE, GB/T	30-31

D 止回阀系列 CHECK VALVE

旋启式止回阀 SCREW SWING CHECK VALVE	32
Y型止回阀 Y-TYPE CHECK VALVE	33
立式止回阀 VERTICAL CHECK VALVE	34
国标旋启式法兰止回阀 FLANGED SWING CHECK VALVE, GB/T	35-36
美标旋启式法兰球阀 FLANGED SWING CHECK VALVE, ENDS. ASME	37
对夹式弹簧止回阀 SPRING LOADED WAFER CHECK VALVE	38
双瓣对夹式止回阀 DUAL-PLATE WAFER CHECK VALVE	39-40

E 过滤器系列 STRAINER

Y型过滤器 Y-TYPE STRAINER	41
法兰Y型过滤器 FLANGE Y-TYPE STRAINER	42

F 螺纹管件系列 SCREWED PIPE FITTINGS

不锈钢快装接头系列 STAINLESS STEEL CAMLOCK AND GROVED COUPLINGS SERIES	43-44
丝扣管件 SCREWED END FITTINGS	45



1-PC BALL VALVE REDUCE PORT 1000WOG, PN63



PRODUCTS STANDARD

- ◆Blow-Out Proof Stem 防脱出阀杆
- ◆Investment Casting Body 精密铸造阀体
- ◆All Kinds Of Thread Available 各种标准螺纹
- ◆Locking Device Handle Available 带锁手柄选配
- ◆Reduce port 缩径
- ◆Thread Acc H 螺纹标准: ANSI B1.20.1
BS 21, DIN 2999, ISO 7-1
- ◆Inspection & Testing Acc 检测标准: API 598
- ◆Seat: PTFE, Glass filled PTFE, Carbon filled PTFE available

Pressure-Temperature Rating 1/4"~4"

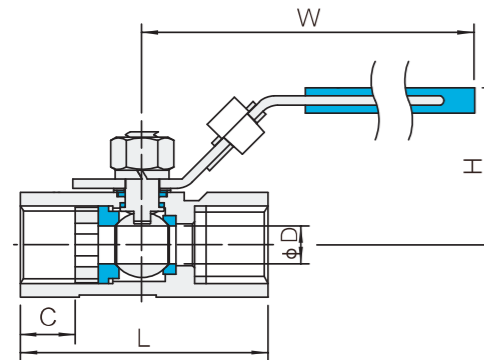
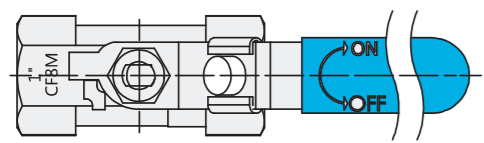
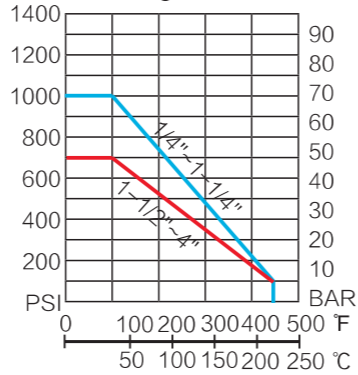

Size	φd	L	H	W	C	Torque N.M	End
1/4"	5	40	28	75	10	3	BSPT NPT BSPP
3/8"	7	45	31	90	10.5	3	
1/2"	9	57	34	95	13.5	3	
3/4"	12	60	43	95	14	4.5	
1"	15	72	52	111	16.5	5	
1-1/4"	20	78	52	124	19	7	
1-1/2"	25	89	65	139	19	8	
2"	32	102	70	152	23.5	16	
2-1/2"	38	126	95	200	31.5	21	
3"	48	150	102	200	32	26	
4"	65	192	133	250	44	40	

2-PC BALL VALVE FULL PORT 1000WOG, PN63



PRODUCTS STANDARD

- ◆Blow-Out Proof Stem 防爆阀杆
- ◆Investment Casting Body 精密铸造阀体
- ◆Full Port 全通径设计
- ◆All Kinds Of Thread Available 各种螺纹标准
- ◆Locking Device Handle Available 带锁手柄选配
- ◆Thread Acc 螺纹标准: ANSI B1.20.1
BS 21, DIN 2999, ISO 7-1
- ◆Inspection & Testing Acc 检测标准: API 598
- ◆Seat: PTFE, Glass filled PTFE, Carbon filled PTFE available

Pressure-Temperature Rating 1/4"~4"

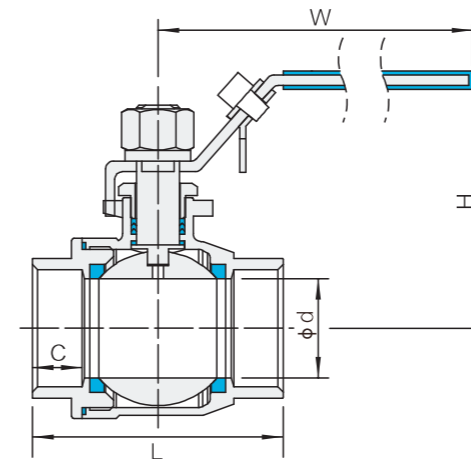
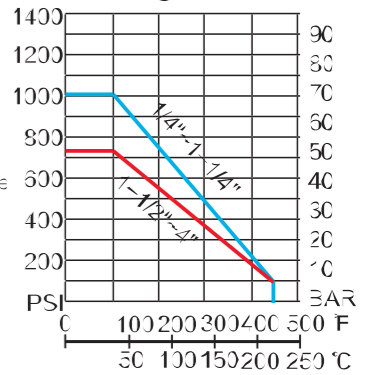

Size	φd	L	H	W	C	Torque N.M	End
1/4"	10.5	48	51.5	100	10	4	BSPP BSPT NPT PT DN ...
3/8"	10.5	46	51.5	100	10	4	
1/2"	14	58	57.5	100	12.5	5	
3/4"	19	64	64.5	120	13	7	
1"	24	76	68	120	15.5	9	
1-1/4"	31	87	79.5	150	17.5	16	
1-1/2"	38	96	90.5	170	18	23	
2"	48	114	98	170	18	26	
2-1/2"	64	142	122	250	24	50	
3"	76	164	132	250	27.5	86	
4"	98	197	163	300	28	118	

主要构件材料 Materials of Main Construction

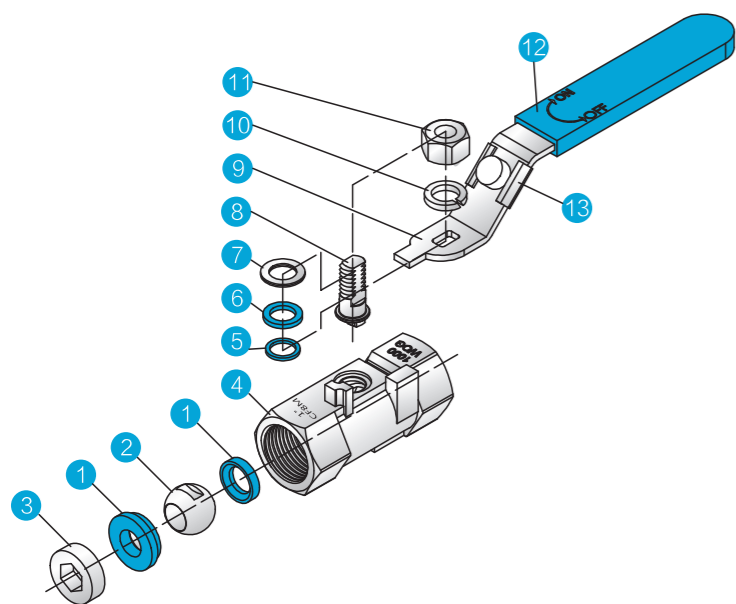

Item No.	Part Name	Material
1	Seat 阀座	PTFE
2	Ball 阀球	SS316 SS304
3	Cap Plug 压盖	CF8M CF8
4	Body 阀体	CF8M CF8 WCB
5	Thrust Washer 垫圈	PTFE
6	Stem Packing 密封圈	PTFE
7	Gland Ring 垫圈	SS304
8	Stem 阀杆	SS316 SS304
9	Handle 手柄	SS201
10	Spring Washer 弹簧垫圈	SS304
11	Stem Nut 螺母	SS304
12	Handle Cover 手柄皮套	PLASTIC
13	Locking Device 锁定装置	SS201

主要构件材料 Materials of Main Construction

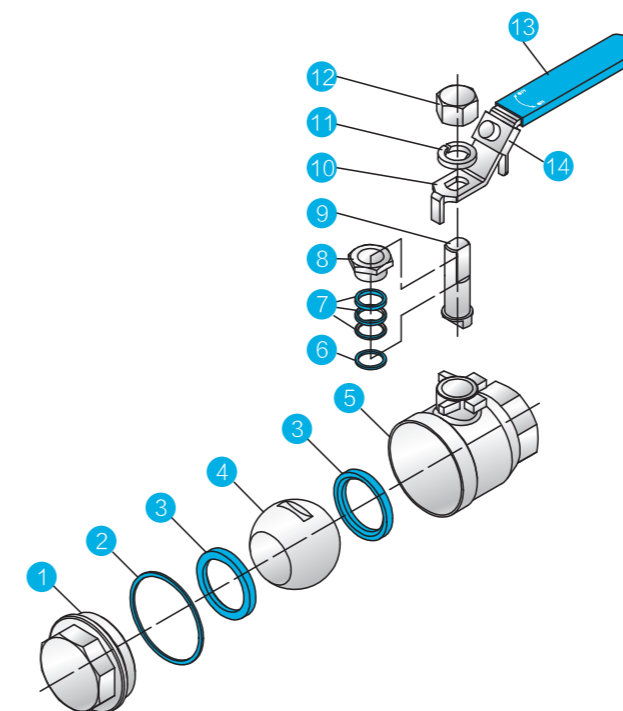

Item No.	Part Name	Material
1	Cap 阀盖	CF8M CF8 WCB
2	Body Gasket 垫圈	PTFE
3	Seal Seat 阀座	PTFE R-PTFE
4	Ball 阀球	SS316 SS304
5	Body 阀体	CF8M CF8 WCB
6	Thrust Washer 垫圈	PTFE
7	Stem Packing 填料密封	PTFE
8	Gland Ring 上环螺母	SS304
9	Stem 阀杆	SS316 SS304
10	Handle 手柄	SS201
11	Spring Washer 弹簧垫圈	SS304
12	Stem Nut 阀杆螺母	SS304
13	Handle Cover 手柄皮套	Plastic
14	Locking Device 锁定装置	SS201

2-PC BALL VALVE FULL PORT ,PN63 DIN STANDARD



PRODUCTS STANDARD

- ◆Blow-Out Proof Stem 防爆阀杆
- ◆Investment Casting Body 精密铸造阀体
- ◆Full Port 全通径设计
- ◆Face to Face: DIN3202-M3 长度: DIN3202-M3
- ◆All Kinds Of Thread Available 各种螺纹标准
- ◆Locking Device Handle Available 带锁手柄选配
- ◆Design Acc: ASME B16.34 设计标准: ANSI B16.34
- ◆Thread Acc 螺纹标准: ANSIB1.20.1
BS 21, DIN 2999, ISO 7-1
- ◆Inspection & Testing Acc 检测标准: API 598
- ◆Seat: PTFE, Glass filled PTFE Carbon filled PTFE available

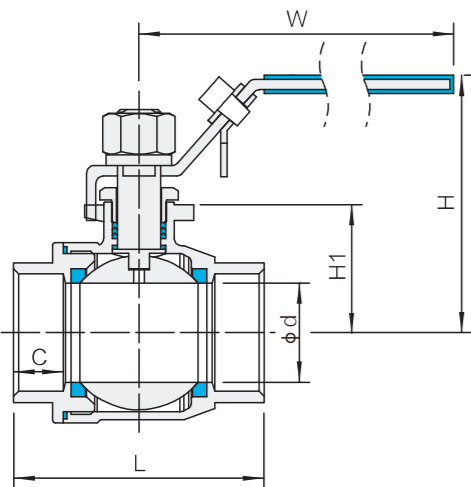
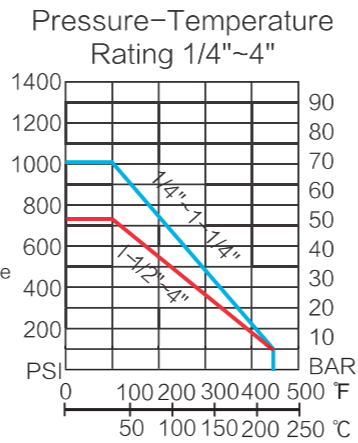

Size	φd	L	H	H1	W	C	Torque N.M	End
1/4"	10.5	50	51.5	20.5	98	11	4	BSP BSPT NPT PT DIN ...
3/8"	12	60	58	25	98	12	4	
1/2"	15	75	64.5	28	120	16	5	
3/4"	20	80	67	30.5	120	16	7	
1"	25	90	78.5	39	150	19	9	
1-1/4"	32	110	83.5	44	150	22	16	
1-1/2"	38	120	98	54	170	23	23	
2"	48	140	107	63	170	25	26	
2-1/2"	65	185	133	80.5	250	36	50	
3"	78	205	143.5	91	250	36	86	
4"	98	240	168	107.5	300	41.5	118	

2-PC BALL VALVE FULL PORT 2000WOG



PRODUCTS STANDARD

- ◆Blow-Out Proof Stem 防爆出阀杆
- ◆Investment Casting Body 精密铸造阀体
- ◆Full Port 全通径设计
- ◆2000PSI, PN120
- ◆All Kinds Of Thread Available 各种螺纹标准
- ◆Locking Device Handle Available 带锁手柄选配
- ◆Design Acc: ASME B16.34 设计标准: ANSI B16.34
- ◆Thread Acc 螺纹标准: ANSIB1.20.1
BS 21, DIN 2999, ISO 7-1
- ◆Inspection & Testing Acc 检测标准: API 598
- ◆Seat: PTFE, Glass filled PTFE Carbon filled PTFE available

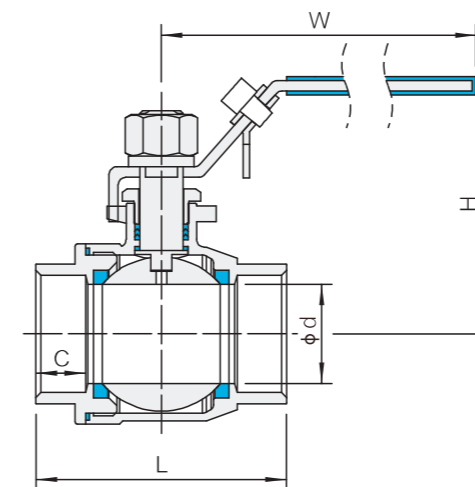
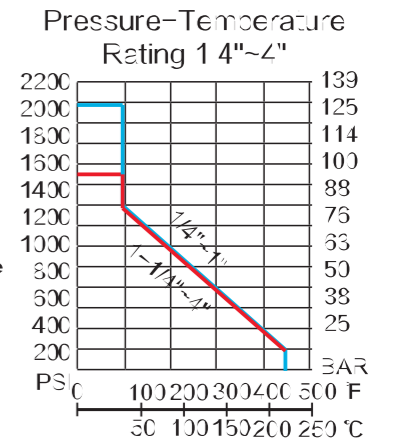

Size	φd	L	H	W	C	Torque N.m	End
1/4"	10.5	58	58	100	11	4	BSP BSPT NPT DIN ...
3/8"	10.5	58	58	100	12	4	
1/2"	15	65	62.5	120	13.5	5	
3/4"	20	73	67	135	14.5	7	
1"	25	82	80.5	160	17.5	9	
1-1/4"	32	92	85.5	160	19	16	
1-1/2"	38	109	102	180	21	23	
2"	48	122	110	180	23	26	

主要构件材料 Materials of Main Construction

Item No.	Part Name	Material
1	Cap 阀盖	CF8M CF8 WCB
2	Body Gasket 垫圈	PTFE
3	Seal Seat 阀座	PTFE R-PTFE
4	Ball 阀球	SS316 SS304
5	Body 阀体	CF8M CF8 WCB
6	Thrust Washer 垫圈	PTFE
7	Stem Packing 填料密封	PTFE
8	Gland Ring 止动螺母	SS304
9	Stem 阀杆	SS316 SS316
10	Handle 手柄	SS201
11	Spring Washer 弹簧垫圈	SS304
12	Stem Nut 阀杆螺母	SS304
13	Handle Cover 手柄皮套	Plastic
14	Locking Device 锁定装置	SS201

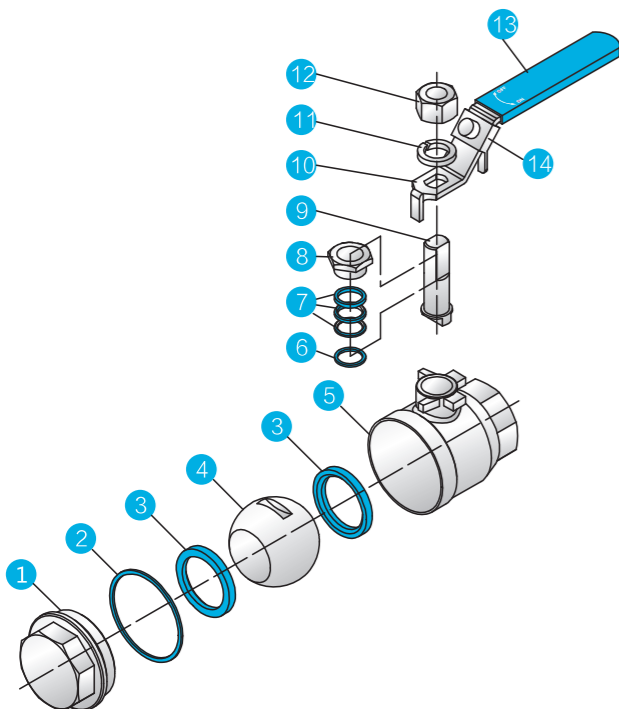

主要构件材料 Materials of Main Construction

Item No.	Part Name	Material
1	Cap 阀盖	CF8M CF8 WCB
2	Body Gasket 垫圈	PTFE
3	Seal Seat 阀座	PTFE R-PTFE
4	Ball 阀球	SS316 SS304
5	Body 阀体	CF8M CF8 WCB
6	Thrust Washer 垫圈	PTFE
7	Stem Packing 填料密封	PTFE
8	Gland nut 止动螺母	SS304
9	Stem 阀杆	SS316 SS304
10	Handle 手柄	SS201
11	Spring Washer 弹簧垫圈	SS304
12	Stem Nut 阀杆螺母	SS304
13	Locking Device 锁定装置	SS201

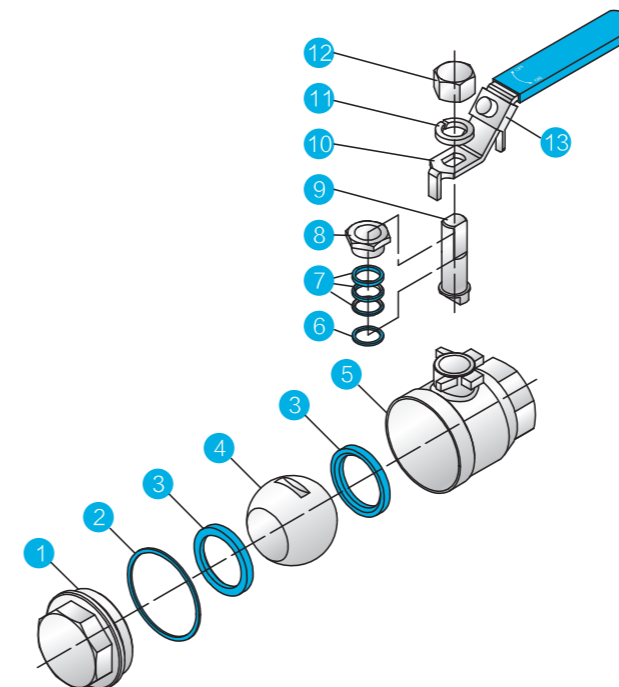

2-PC ECONOMICAL BALL VALVE



特征:

通径设计
工作压力: 600PSI(PN40)
工作温度: -20°C~250°C
(-4° F~482° F) 1/4"-4"
硅溶胶阀体及阀盖/防吹出阀杆
驱动方式: 手动

螺纹端可按:
ANSI B1.20.1(NPT螺纹)
ISO228/1 & DIN259(BSP、G螺纹)
DIN2999 & BS21(BSPT螺纹)

Features:

Full Port
W.P.: 600PSI(PN63)
W.T.: -20°C~250°C
(-4° F~482° F) 1/4"-4"
Investment Casting Body & Cap
Blow-Out Proof Stem
Type of Drive: Manual

Thread End:
ANSI B1.20.1(NPT)
ISO228/1 & DIN259(G)
DIN2999 & BS21(BSPT)

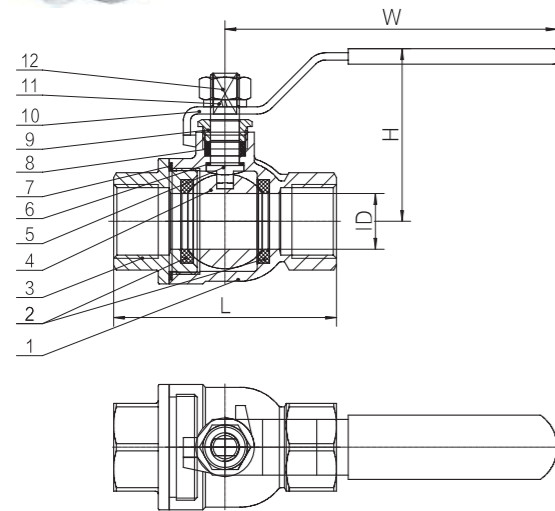

主要构件材料 Materials of Main Construction

No.	部件名称	Component Name	材料Material		
1	阀体	Body	CF8M	CF8	WCB
2	阀座	Seat	PTFE	PTFE	PTFE
3	阀盖	Bonnet	CF8M	CF8	WCB
4	球	Ball	SS316	SS304	SS304
5	阀杆	Stem	SS316	SS304	SS304
6	垫片	Gasket	PTFE	PTFE	PTFE
7	弹性垫圈	Sealring	PTFE	PTFE	PTFE
8	阀杆填料	Packing	PTFE	PTFE	PTFE
9	填料压盖	Packing Gland	SS304	SS304	SS202
10	手柄	Handle	SS201	SS201	SS202
11	弹簧垫圈	Spring Washer	SS304	SS304	SS202
12	六角螺母	Hexnut	SS304	SS304	SS202
13	锁片	Lock	SS201	SS201	SS202

主要尺寸 Dimensions

NPS	DN	ID	L	H	W
1/4"	8A	6.1	56.2	50.1	82
3/8"	10A	6.1	56.8	50.1	82
1/2"	15A	7	65	58	99
3/4"	20A	7.1	71.6	64.5	99
1"	25A	7.8	83.3	75.5	115
1-1/4"	32A	8.5	96.9	88.4	128
1-1/2"	40A	8.8	106.5	97.7	155

2-PC KOREAN BALL VALVE



特征:

通径设计
工作压力: 600PSI(PN40)
工作温度: -20°C~250°C(-4° F~482° F) 1/4"-4"
硅溶胶阀体及阀盖/防吹出阀杆
驱动方式: 手动

螺纹端可按:
ANSI B1.20.1(NPT螺纹)
ISO228/1 & DIN259(BSP、G螺纹)
DIN2999 & BS21(BSPT螺纹)

Features:

Full Port
W.P.: 600PSI(PN63)
W.T.: -20°C~250°C(-4° F~482° F) 1/4"-4"
Investment Casting Body & Cap
Blow-Out Proof Stem
Type of Drive: Manual

Thread End:
ANSI B1.20.1(NPT)
ISO228/1 & DIN259(G)
DIN2999 & BS21(BSPT)

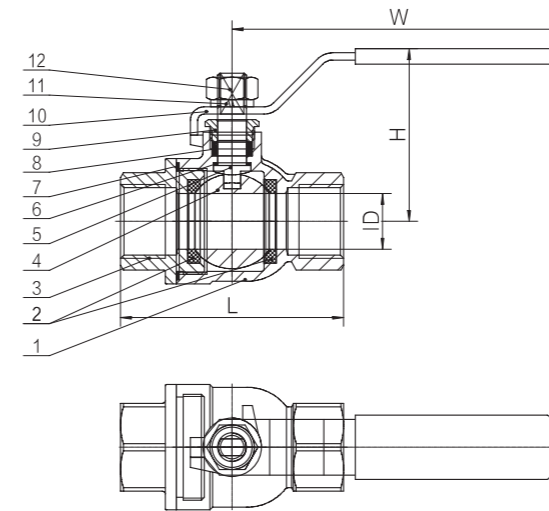

主要构件材料 Materials of Main Construction

No.	部件名称	Component Name	材料Material		
1	阀体	Body	CF8M	CF8	WCB
2	阀座	Seat	PTFE	PTFE	PTFE
3	阀盖	Bonnet	CF8M	CF8	WCB
4	球	Ball	SS316	SS304	SS304
5	阀杆	Stem	SS316	SS304	SS304
6	垫片	Gasket	PTFE	PTFE	PTFE
7	弹性垫圈	Sealring	PTFE	PTFE	PTFE
8	阀杆填料	Packing	PTFE	PTFE	PTFE
9	填料压盖	Packing Gland	SS304	SS304	SS202
10	手柄	Handle	SS201	SS201	SS202
11	弹簧垫圈	Spring Washer	SS304	SS304	SS202
12	六角螺母	Hexnut	SS304	SS304	SS202
13	锁片	Lock	SS201	SS201	SS202

主要尺寸 Dimensions

NPS	DN	ID	L	H	W
1/2"	15A	7.5	63.8	56.3	99
3/4"	20A	7.5	69.9	62.4	99
1"	25A	7.8	85.1	77.3	115
1-1/4"	32A	8.2	92.5	84.3	128
1-1/2"	40A			90.8	155
2"	50A	8.5	113.2	104.7	165

2-PC BALL VALVE FULL PORT 1000WOG, ISO-5211 DIRECT MOUNTING PAD



PRODUCTS STANDARD

- ◆Blow-Out Proof Stem 防脱出阀杆
- ◆Investment Casting Body 精密铸造阀体
- ◆Full Port 全通径设计
- ◆ISO5211 Direct Mounting pad 直装平台设计
- ◆Locking Device Handle Available 带锁手柄选配
- ◆Design Acc设计标准: ASME B16.34
- ◆Thread Acc螺纹标准: ANSI B1.20.1、BS 21、DIN 2999、ISO 7-1
- ◆Inspection & Testing Acc 检测标准: API 598
- ◆Seat:PTFE,Glass filled PTFE Carbon filled PTFE available

Pressure-Temperature Rating 1/4"~4"

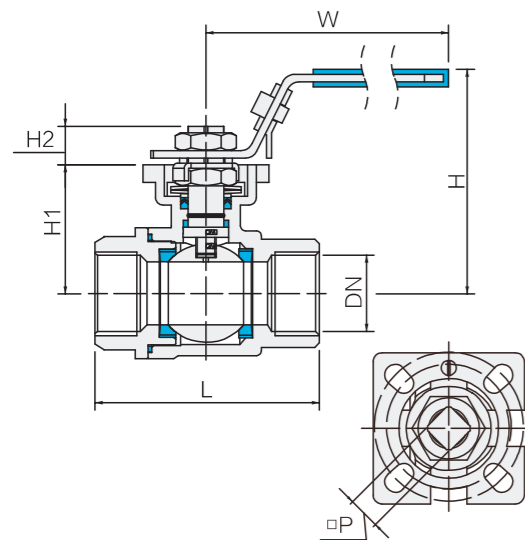
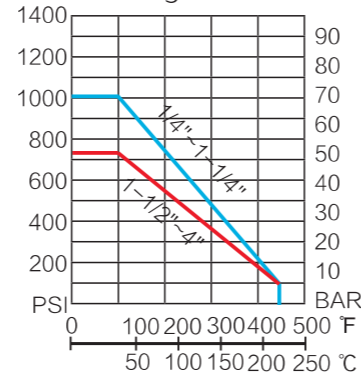

Size	DN	L	H	H1	H2	W	□ P	Torque N.M	ISO5211
1/4"	10	50	57	30	7.5	110	9	4	F03/F04
3/8"	12	50	57	30	7.5	110	9	4	F03/F04
1/2"	15	60	65	37	8	110	9	5	F03/F04
3/4"	20	70	67	40	8	110	9	7	F03/F04
1"	25	90	80	49	10	130	11	9	F04/F05
1-1/4"	32	95	83	53	10	160	11	16	F04/F05
1-1/2"	38	106	99	62	14	185	14	21	F05/F07
2"	48	120	107	70	14	185	14	25	F05/F07
2-1/2"	65	160	165	93	18.5	250	17	48	F07/F10
3"	78	180	180	106	18.5	250	17	82	F07/F10
4"	98	220	200	126	18.5	310	19	113	F07/F10

3-PC BALL VALVE FULL PORT 1000WOG, PN63



PRODUCTS STANDARD

- ◆Blow-Out Proof Stem 防脱出阀杆
- ◆Investment Casting Body 精密铸造阀体
- ◆Full Port 全通径设计
- ◆Locking Device Handle Available 带锁手柄
- ◆Thread Acc螺纹标准: ANSI B1.20.1、BS 21、DIN 2999、ISO 7-1
- ◆Inspection & Testing Acc 检测标准: API 598
- ◆Seat:PTFE,Glass filled PTFE Carbon filled PTFE available

Pressure-Temperature Rating 1/4"~4"

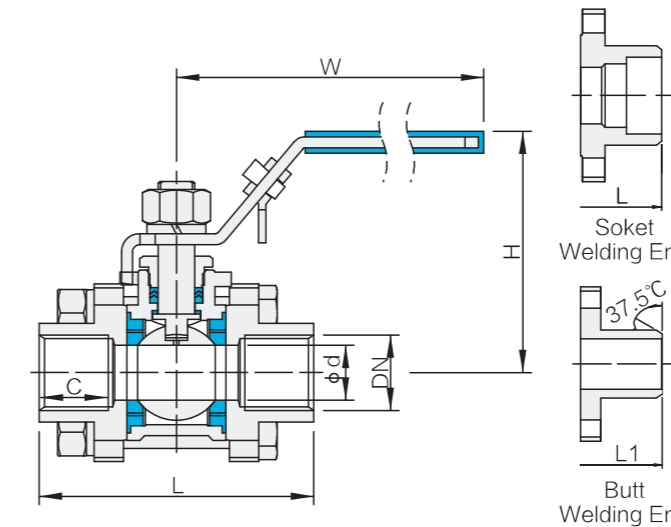
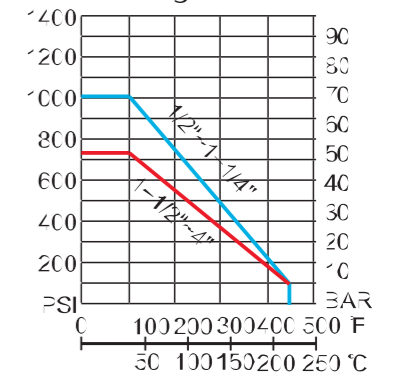

Size	DN	L	L1	H	W	C
1/4"	8	63	63	54	100	13
3/8"	10	63	63	54	100	13
1/2"	15	63	65	58.5	100	13.5
3/4"	20	70	76	64.5	120	14.5
1"	25	82	86	68	120	17
1-1/4"	32	92	98	79.5	130	18.5
1-1/2"	40	104	114	90.5	170	19
2"	50	115	132	98	170	22.5
2-1/2"	65	190	154	123	210	29
3"	80	205	182	133.5	250	29.5
4"	100	270	235	162.5	300	33

L1=Butt Welding End length

主要构件材料 Materials of Main Construction

Item No.	Part Name	Material
1	Cap 阀盖	CF8M CF8 WCB
2	Body 阀体	CF8M CF8 WCB
3	Seal Gasket 垫圈	PTFE R-PTFE
4	Seat 阀座	PTFE R-PTFE
5	Ball 球体	SS316 SS304
6	Thrust Washer 垫圈	PTFE
7	O-Ring O型圈	VITON
8	Stem Packing 填料密封	PTFE
9	Gland 压套	SS304
10	Spring Washer 蝶簧	SS304
11	Gland Nut 止动螺母	SS304
12	Stop Washer 止动垫圈	SS304
13	Gland 压套	SS304
14	Handle 手柄	SS201
15	Stem Nut 阀杆螺母	SS304
16	Handle Cover 手柄皮套	Plastic
17	Locking Device 锁定装置	SS201
18	Stem 阀杆	SS316 SS304
19	Locking Bolt 定位螺栓	SS304

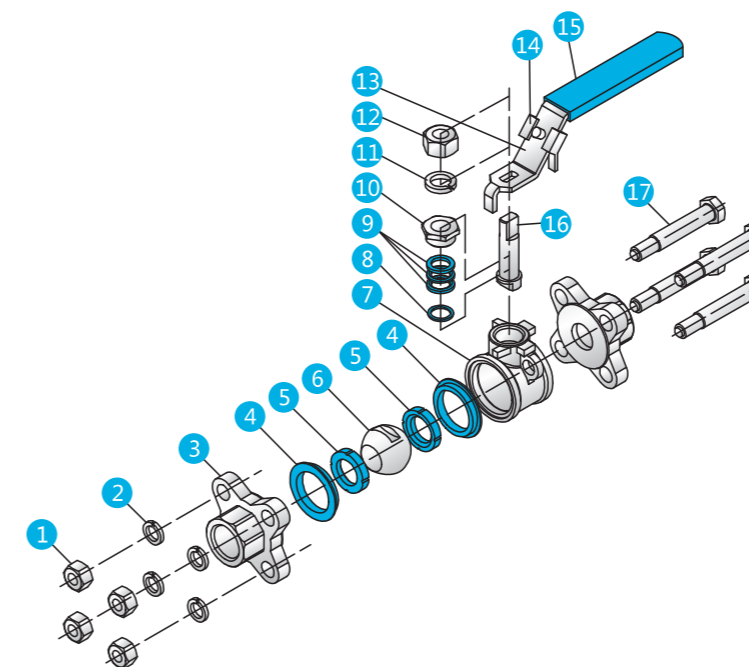

主要构件材料 Materials of Main Construction

Item No.	Part Name	Material
1	Nut 螺母	A2-70
2	Spring Washer 弹簧垫片	SS304
3	Cap 阀盖	CF8M CF8 WCB
4	Body Gasket 垫圈	PTFE R-PTFE
5	Seal Seat 阀座	PTFE R-PTFE
6	Ball 阀球	SS316 SS304
7	Body 阀体	CF8M CF8 WCB
8	Thrust Washer 垫圈	PTFE
9	Stem Packing 填料密封	PTFE
10	Gland Nut 止动螺母	SS304
11	Spring Washer 弹簧垫圈	SS304
12	Stem Nut 阀杆螺母	SS304
13	Handle 手柄	SS201
14	Locking Device 锁定装置	SS201
15	Handle Cover 手柄皮套	Plastic
16	Stem 阀杆	SS316 SS304
17	Bolt 螺栓	A2-70

3-PC BALL VALVE FULL PORT 1000WOG, PN63
ISO-5211 DIRECT MOUNTING PAD



PRODUCTS STANDARD

- ◆Blow-Out Proof Stem 防脱出阀杆
- ◆Investment Casting Body 精密铸造阀杆
- ◆Full Port 全通径设计
- ◆ISO5211 Dircet Mounting pad 直装式平台
- ◆Locking Device Handle Available 带锁手柄
- ◆Design Acc 设计标准: ASME B16.34
- ◆Thread Acc 螺纹标准: ANSI B1.20.1 BS 21
DIN 2999 ISO 7-1
- ◆Inspection & Testing Acc 检测标准: API 598
- ◆Seat:PTFE.Glass filled PTFE Carbon filled PTFE available

Pressure-Temperature
Rating 1/2"~4"

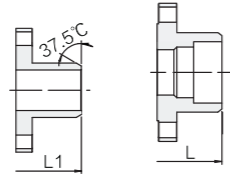
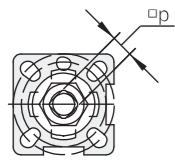
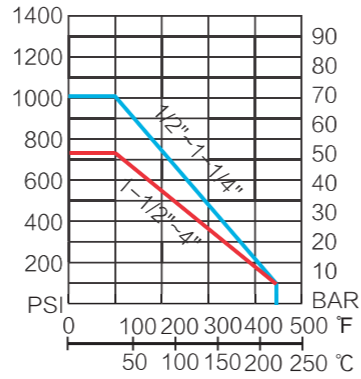

Butt Welding End Somet Welding End

Size	DN	L	L1	H	H1	H2	W	□P	A	Torque N.M	ISO5211
1/2"	15	75	75	70	40	7	120	9	22.5	5	F03/F04
3/4"	20	80	90	80	50	9	120	9	27	7	F03/F04
1"	25	90	100	90	57	11	135	11	34.5	10	F04/F05
1-1/4"	32	110	110	95	61	11	150	11	43	16	F04/F05
1-1/2"	40	120	125	105	76	14	185	14	49	22	F05/F07
2"	48	140	150	112	84	14	185	14	62	27	F05/F07
2-1/2"	65	185	190	174	100	16	248	17	76.5	49	F07/F10
3"	80	205	220	185	111	16	248	17	92	83	F07/F10
4"	100	240	270	205	130	16.5	310	19	115.5	115	F07/F10

L1=Butt Welding End length

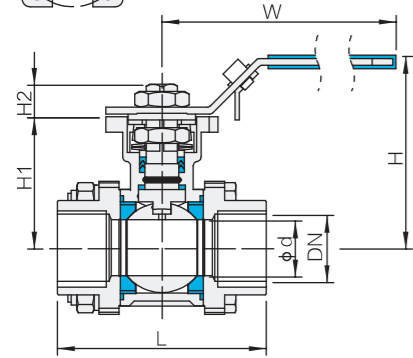

3PC BALL VALVE 2000 WOG
(DIRECT MOUNTING PAD)



性能规范 Specifications

公称压力 Nominal pressure	2000WOG
强度试验压力 Strength testing pressure	12MPa
低压气密封试验压力 Seal Testing Pressure(Low Pressure)	0.6MPa
适用温度 applicable temperature	-20~80℃

主要构件材料 Main Parts and Material

部件 Part Name	材料 Material
阀体 Body	WC3/C-F8
阀盖 Bonnet	WC3/C-F8
球体 Ball	304
阀杆 Stem	304
密封圈 Seal gase	聚四氟乙烯 PTFE
填料 Packing	聚四氟乙烯 PTFE

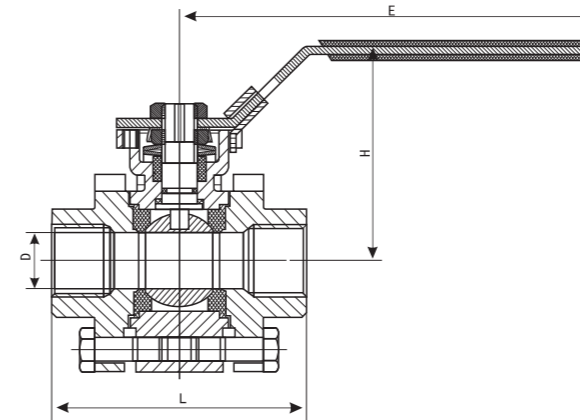

主要尺寸 Dimensions

DN	L	D	H	E
15	74	14	72	145
20	88	19	77	145
25	90	24	82	163
32	110	32	86	163
40	120	36	106	206
50	140	39	114	206

主要构件材料 Materials of Main Construction

Item No.	Part Name	Material
1	Nut 螺母	SS304
2	Spring Washer 弹簧垫圈	SS304
3	Cap 阀盖	CF8M CF8 WCB
4	Body Gasket 垫圈	PTFE R-PTFE
5	Seal Seat 阀座	PTFE R-PTFE
6	Ball 球	SS316 SS304
7	Thrust Washer 垫圈	PTFE
8	O-Ring O型圈	VITON
9	Stem V-Ring Packing 阀杆V型密封	PTFE R-PTFE
10	Gland 压套	SS304
11	Belleville Washer 蝶簧	SS304
12	Gland nut 止动螺母	SS304
13	Stop Washer 止动垫圈	SS304
14	Gland 压套	SS304
15	Stem Nut 阀杆螺母	SS304
16	Locking Device 锁定装置	SS304
17	Handle Cover 手柄皮套	PLASTIC
18	Handle 手柄	SS201
19	Stem 阀杆	SS316 SS304
20	Thrust Gasket 止推垫片	PTFE
21	Body 阀体	CF8M CF8 WCB
22	Bolt 螺栓	SS304

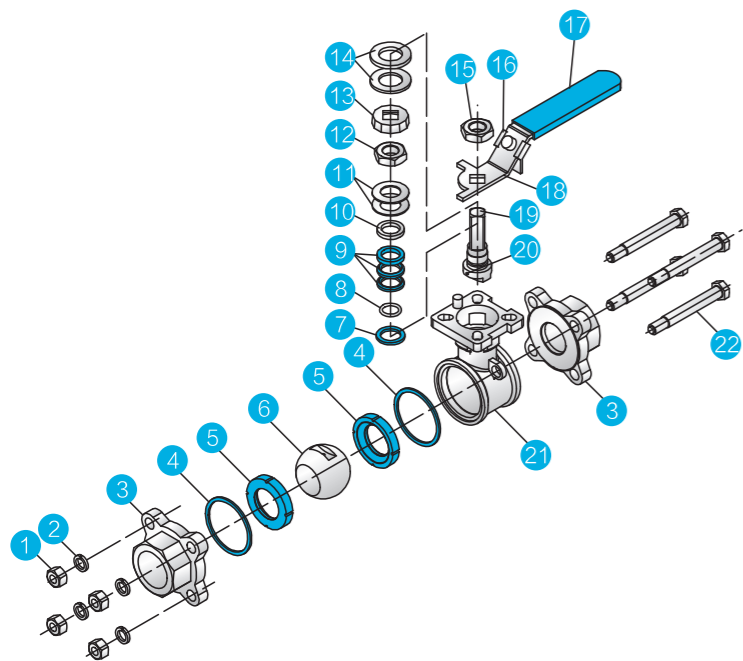

3PC CLAMPED-END BALL VALVE

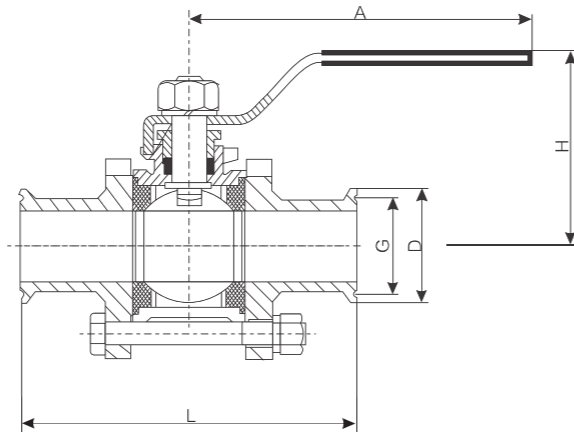

性能规范 Specifications

公称压力 Nominal pressure	1000WOG
强度试验压力 Strength testing pressure	1.6MPa
低压密封试验压力 Seal test pressure(low pressure)	0.6MPa
高压密封试验压力 Seal test pressure(high pressure)	1.0MPa
适用介质 Applicable medium	水、油品、气 Water, oil, gas
适用温度 Applicable temperature	-40~120℃

主要构件材料 Materials of Main Construction

部件 Part Name	材质 Material		
阀体 Valve body	WCB	304	316
球体 Ball	304	304	316
阀杆 Stem	304	304	316
密封圈 Seal gasket	聚四氟乙烯 PTFE		
填料 Packing	聚四氟乙烯 PTFE		

主要尺寸 Dimensions

Unit:mm

DN	G	D	L	H	A
15	1/2#	34	95	68	125
20	3/4#	50.5	105	70	125
25	1#	50.5	115	80	145
32	1 1/4#	50.5	125	84	145
40	1 1/2#	50.5	135	93	205
50	2#	64	150	100	205
65	2 1/2#	91	190	142	250
80	3#	106	220	155	250

3-WAY BALL VALVE 1000WOG, PN63
ISO-5211 DIRECT MOUNTING PAD



- PRODUCTS STANDARD
- ◆Blow-Out Proof Stem 防脱出阀杆
 - ◆Investment Casting Body 精密铸造阀体
 - ◆Reduce Port 缩径设计
 - ◆L/T Port Upon Request L和T型设计
 - ◆ISO 5211 Direct Mounting Pad 直装型平台设计
 - ◆Locking Device Handle Available 带锁手柄选配
 - ◆Design Acc设计标准: ASME B16.34
 - ◆Thread Acc螺纹标准: ANSI B1.20.1
 - BS 21 DIN 2999 ISO 7-1
 - ◆Inspection & Testing Acc检测标准: API598
 - ◆Seat:PTFE.Glass filled PTFE Carbon filled PTFE available

Pressure-Temperature Rating 1/4"~4"

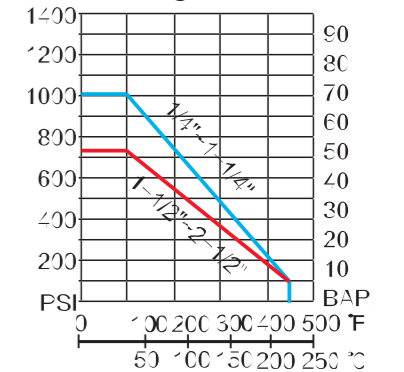

2-1/2 Size on application

Size	Ød	L	H	H1	H2	W	□P	Torque N.M	ISO5211
1/4"	12	68	71	39	9	120	9	5	FC3/F04
3/8"	12	68	71	39	9	120	9	7	FC3/F04
1/2"	12	68	71	39	9	120	9	10	FC3/F04
3/4"	15	88	74	42.5	9	120	9	16	FC3/F04
1"	20	90	90	49	11	135	11	22	FC4/F05
1-1/4"	25	105	95	50	11	187	11	27	FC4/F05
1-1/2"	32	135	99	63.5	14	187	14	49	FC5/F07
2"	38	149	108	77	14	187	14	83	FC5/F07

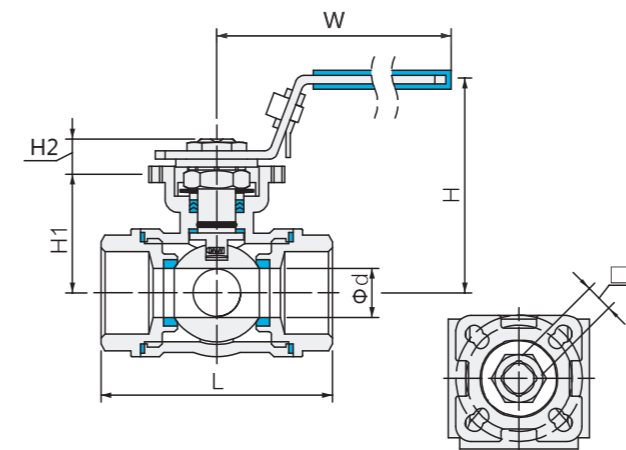

主要构件材料 Materials of Main Construction

Item No.	Part Name	Material	
1	Cap 阀盖	CF8M	CF8 WCB
2	Body Gasket 阀体密封	PTFE	
3	Seat 阀座	PTFE	P-PTFE
4	Ball 阀球	SS316	SS304
5	Body 阀体	PTFE	P-PTFE
6	Thrust Washer 推力垫圈	PTFE	
7	O-Ring O型圈	VTON	
8	Packing 填料	PTFE	
9	Gland 压套	SS304	
10	Belleville Washer 蝶簧	SS304	
11	Gland nut 上压螺母	SS304	
12	Stop Washer 紧压垫圈	SS304	
13	Gasket 垫圈	SS304	
14	Stem Nut 阀杆螺母	SS304	
15	Handle 手柄	SS201	
16	Locking Device 锁定装置	SS201	
17	Handle Cover 手柄罩套	PLASTIC	
18	Stem 阀杆	SS316	SS304

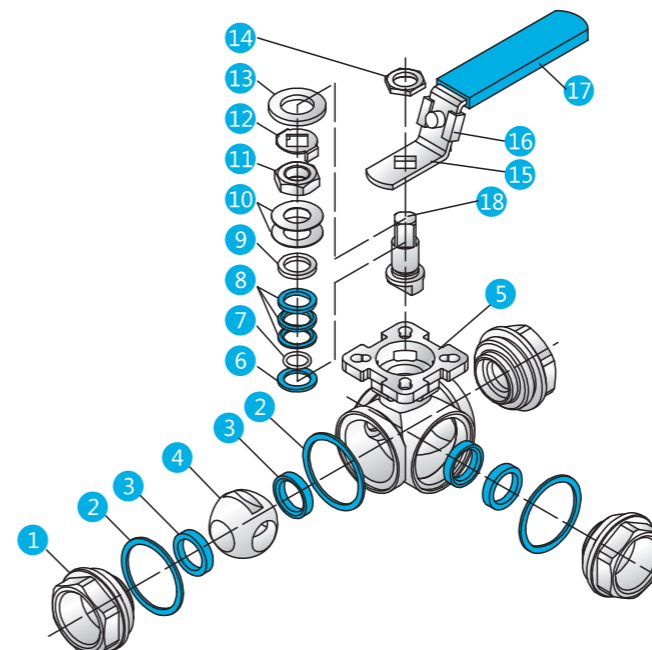

WAFER BALL VALVE, FULL PORT, PN16-40 ISO-DIRECT MOUNTING PAD



PRODUCTS STANDARD

- ◆ Blow-Out Proof Stem 防脱出阀杆
- ◆ Investment Casting Body 精密铸造阀体
- ◆ Full Port 全通路设计
- ◆ Belleville Washer for Self-Adjustment 蝶簧中头填料自动调节
- ◆ ISO5211 Direct Mounting Pad 带直装平台设计
- ◆ Flange Standard 法兰标准: DIN2633
- ◆ Design Acc 设计标准: ASME B16.34
- ◆ Inspection & Testing Acc 检测标准: API 598
- ◆ Seat: PTFE, Glass filled PTFE, Carbon filled PTFE available

Pressure-Temperature Rating 1/2"~4"

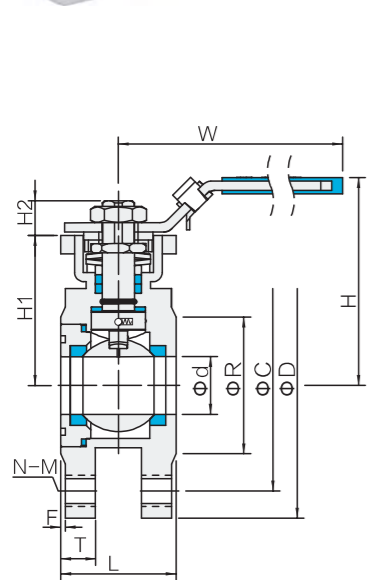
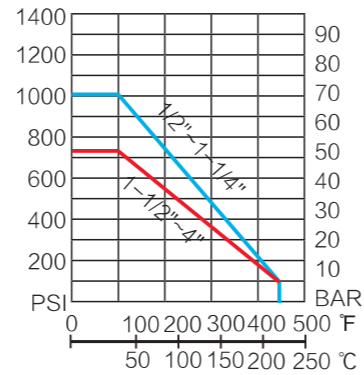

PN	Size	φd	L	H	H1	H2	φR	φC	φD	W	T	F	□P	N-M	ISO 5211	Torque N.M
16	1/2"	15	35	77	48.5	9	45	65	95	120	10	2	9	4-M12	F03/F04	4
	3/4"	20	42	85	54	9	58	75	105	120	12	2	9	4-M12	F03/F04	5
	1"	25	48	94	60	11	68	85	115	137	15	2	11	4-M12	F04/F05	5
40	1-1/4"	32	55	104	72	11	78	100	140	187	15	2	11	4-M12	F04/F05	7
	1-1/2"	38	65	114	77	14	88	100	145	187	16	3	14	4-M16	F05/F07	9
	2"	50	75	120	86	14	102	125	160	187	18	3	14	4-M16	F05/F07	16
	2-1/2"	65	95	160	108	17	122	145	180	315	18	3	17	4-M16	F07/F10	21
16	3"	80	118	170	116	17	138	160	195	315	20	3	17	8-M16	F07/F10	25
	4"	100	140	182	138	17	162	190	215	315	20	3	19	8-M16	F07/F10	46



主要构件材料 Materials of Main Construction

Item No.	Part Name	Material
1	Cap 阀盖	CF8M CF8 WCB
2	Body Gasket 阀体密封	PTFE
3	Ball Seat 阀座	PTFE
4	Ball 球	SS316 SS304
5	Body 阀体	CF8M CF8 WCB
6	Thrust Washer 密封垫圈	PTFE
7	O-Ring O型圈	VITON
8	V-Ring Packing V型填料	PTFE
9	Gland nut 压盖	SS304
10	Belleville Washer 蝶簧	SS301
11	Stop Nut 紧定螺母	SS304
12	Washer 紧定垫圈	SS304
13	Stem Nut 垫圈	SS304
14	Handle cover 手柄皮套	SS304
15	Handle 手柄	SS201
16	Locking 锁定装置	SS201
17	Stem 阀杆	SS316 SS304
18	Locking bolt 定位螺栓	SS304

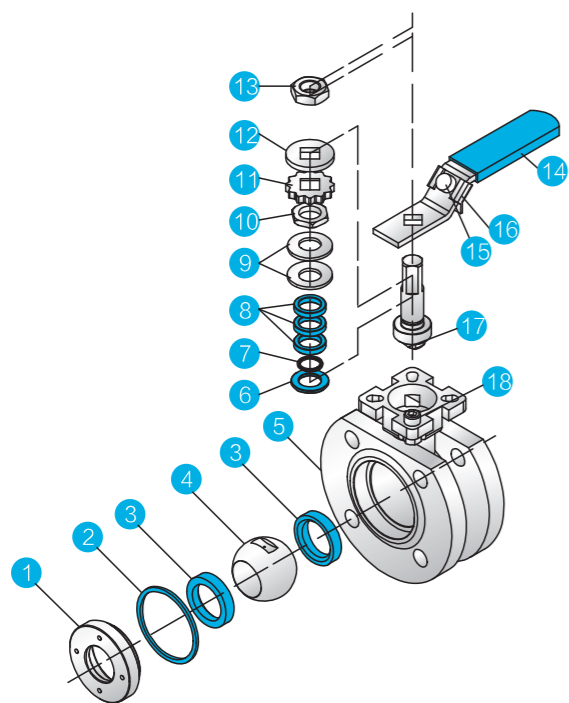

2-PC BALL FLANGE VALVE FULL PORT ISO MOUNTING PAD

PRODUCTS STANDARD

- ◆ Blow-Out Proof Stem 防脱出阀杆
- ◆ Investment Casting Body 精密铸造阀体
- ◆ Full Port 全通径设计
- ◆ Face to Face: ANSI B16.10/JIS B2002/DIN PN16-40
- ◆ Casting Handle 铸造手柄
- ◆ Fire-Safe Design Available Acc: API 607 防火设计
- ◆ Design Acc设计标准: ASME B16.34
- ◆ Flange Standard: ASME 16.5/JIS B2220/DIN 2633
- ◆ Inspection & Testing Acc 检测标准: API 598
- ◆ Seat: PTFE. Glass filled PTFE Carbon filled PTFE available

Pressure-Temperature Rating DN15~DN200

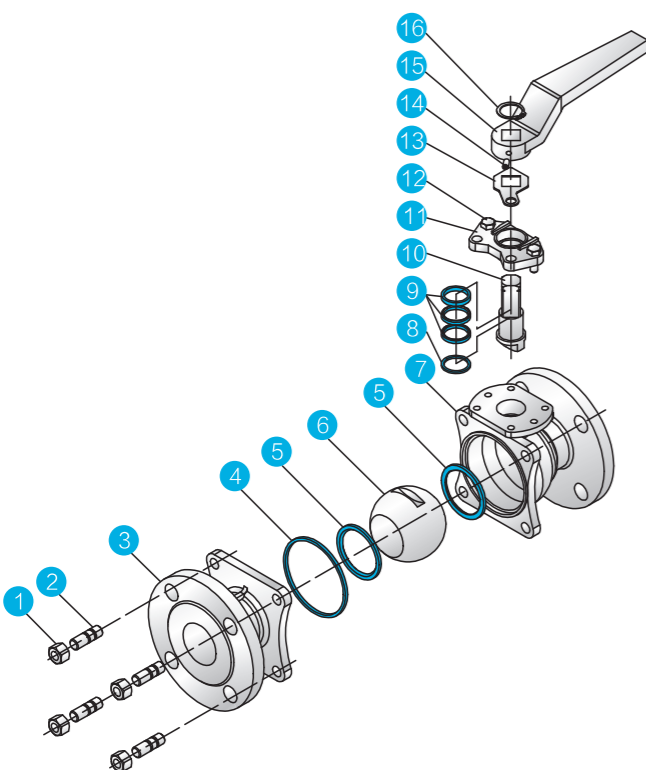
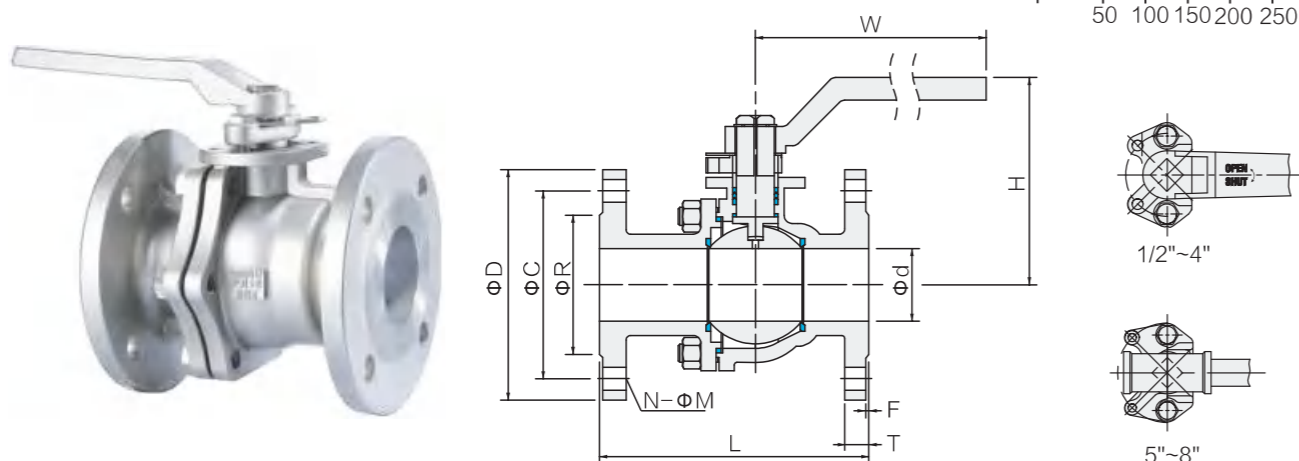
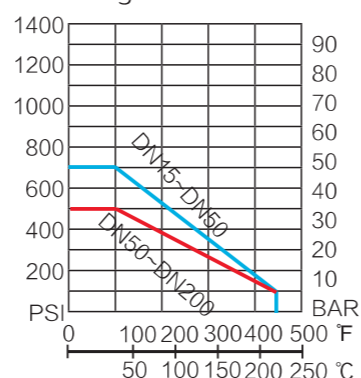

主要构件材料 Materials of Main Construction

Item No.	Part Name	Material
1	Nut 螺母	SS304
2	Stud 螺栓	SS304
3	Cap 阀盖	CF8M CF8 WCB
4	Body Gasket 垫圈	PTFE R-PTFE
5	Seat 阀座	PTFE R-PTFE
6	Ball 球	SS316 SS304
7	Body 阀体	CF8M CF8 WCB
8	Thrust Washer 垫圈	PTFE
9	Stem Packing 填料密封	PTFE
10	Stem 阀杆	SS316 SS304
11	Stop Cap 压盖	SS304
12	Bolt 螺栓	SS304
13	Locking Pin 定位片	SS304
14	Locking Nut 锁紧螺母	SS304
15	Handle 手柄	CF8
16	Stop Washer 定位圈	SS201

ANSI 150# unit:mm

Size	φd	L	H	W	φR	φC	φD	N-φM	T	F	Torque N.M
1/2"	15	108	77.5	148	35	60.5	89	4-16	11.2	1.6	7
3/4"	20	117	79	148	43	70	98	4-16	11.2	1.6	9
1"	25	127	88	148	51	79.5	108	4-16	12.0	1.6	11
1-1/4"	32	140	100	170	64	89	117	4-16	12.7	1.6	18
1-1/2"	38	165	122	230	73	98.5	127	4-16	14.3	1.6	23
2"	50	178	130	230	92	120.5	152	4-19	15.9	1.6	28
2-1/2"	65	190	148	230	105	139.5	178	4-19	17.5	1.6	55
3"	78	203	167	310	127	152.5	190.5	4-19	19.1	1.6	90
4"	100	229	188	310	157	190.5	229	8-19	23.9	1.6	120
5"	125	356	238	500	186	216	254	8-22	23.9	1.6	268
6"	150	394	278.5	645	216	241.5	279	8-22	25.4	1.6	335
8"	200	457	340	845	270	298.5	343	8-22	28.6	1.6	650

JIS 10K unit:mm

Size	φd	L	H	W	φR	φC	φD	N-φM	T	F	Torque N.M
1/2"	15	110	77.5	148	51	70	95	4-15	12	1	7
3/4"	20	120	79	148	56	75	100	4-15	14	1	9
1"	25	130	88	148	67	90	125	4-19	14	1	11
1-1/4"	32	140	100	170	76	100	135	4-19	16	2	18
1-1/2"	38	165	122	230	81	105	140	4-19	16	2	23
2"	50	180	130	230	96	120	155	4-19	16	2	28
2-1/2"	65	190	148	230	116	140	175	4-19	18	2	55
3"	78	200	167	310	126	150	185	8-19	18	2	90
4"	100	230	188	310	151	175	210	8-19	18	2	120
5"	125	300	238	500	182	210	250	8-23	20	2	268
6"	150	340	278.5	645	212	240	280	8-23	22	2	335
8"	200	450	340	845	262	290	330	8-23	22	2	650

DIN PN16 unit:mm

Size	φd	L	H	W	φR	φC	φD	N-φM	T	F	Torque N.M
1/2"	15	115	77.5	148	45	65	95	4-14	14	2	7
3/4"	20	120	79	148	58	75	105	4-14	16	2	9
1"	25	125	88	148	68	85	115	4-14	16	2	11
1-1/4"	32	130	100	170	78	100	140	4-18	16	2	18
1-1/2"	38	140	122	230	88	110	150	4-18	16	3	23
2"	50	150	130	230	102	125	165	4-18	18	3	28
2-1/2"	65	170	148	230	122	145	185	4-18	18	3	55
3"	78	180	167	310	138	160	200	8-18	20	3	90
4"	100	190	188	310	158	180	220	8-18	20	3	120
5"	125	325	238	500	188	210	250	8-18	22	3	268
6"	150	350	278.5	645	212	240	285	8-22	22	3	335
8"	200	400	340	845	268	295	340	12-22	24	3	650

ANSI 300# unit:mm

Size	φd	L	H	W	φR	φC	φD	N-φM	T	F	Torque N.M
1/2"	15	140	80	148	35	66.5	95	4-18	14.5	1.6	7
3/4"	20	152	85	148	43	72.5	107	4-19	15.9	1.6	9
1"	25	165	98	170	51	89	124	4-19	17.5	1.6	11
1-1/4"	32	178	115	170	64	98.5	133	4-19	19.1	1.6	18
1-1/2"	38	190	135	230	73	104.5	156	4-22	20.7	1.6	23
2"	50	216	140	230	92	127	185	8-19	22.3	1.6	28
2-1/2"	65	241	152	310	105	149	190	8-22	25.4	1.6	55
3"	78	283	172	310	127	168	200	8-22	28.6	1.6	90
4"	100	305	195	400	157	200	254	8-22	31.6	1.6	120
5"	125	381	250	550	186	235	279	8-22	35	1.6	268
6"	150	403	285	750	216	270	318	12-22	36.6	1.6	335
8"	200	502	350	900	270	330	381	12-25	41.5	1.6	650

JIS 20K unit:mm

Size	φd	L	H	W	φR	φC	φD	N-φM	T	F	Torque N.M
1/2"	15	140	80	148	51	70	95	4-15	14	1	7
3/4"	20	152	85	148	56	75	100	4-15	16	1	9
1"	25	165	98	170	67	90	125	4-19	16	1	11
1-1/4"	32	178	115	170	76	100	135	4-19	18	2	18
1-1/2"	38	190	135	230	81	105	140	4-19	18	2	23
2"	50	216	140	230	96	120	155	4-19	18	2	28
2-1/2"	65	241	152	310	116	140	175	4-19	20	2	55
3"	78	283	172	310	132	160	200	8-23	22	2	90
4"	100	305	195	400	150	185	225	8-23	24	2	120
5"	125	381	250	550	196	225	270	8-25	26	2	268
6"	150	403	285	750	230	260	305	12-25	28	2	335
8"	200	502	350	900	275	305	350	12-25	30	2	650

DIN PN40 unit:mm

Size	φd	L	H	W	φR	φC	φD	N-φM	T	F	Torque N.M
1/2"	15	115	77.5	148	45	65	95	4-14	16	2	7
3/4"	20	120	79	148	58	75	105	4-14	18	2	9
1"	25	125	88	170	68	85	115	4-14	18	2	11
1-1/4"	32	130	100	170	78	100	140	4-18	18	2	18
1-1/2"	38	140	122	230	88	110	150	4-18	18	3	23
2"	50	150	130	230	102	125	165	4-20	20	3	28
2-1/2"	65	170	148	310	122	145	185	4-22	22	3	55
3"	78	180	167	310	138	160	200	8-24	22	3	90
4"	100	190	188	400	158	180	235	8-24	24	3	120
5"	125	325	238	550	188	210	270	8-26	26	3	268
6"	150	350	278.5	750	212	240	300	8-26	28	3	335
8"	200	400	340	900	268	295	375	12-34	34	3	650

HIGH MOUNTING PAD FLANGED BALL VALVE, ASME



DESIGN FEATURES

- ◆Built-in ISO 5211 Direct Mounting Pad for Easy Automation
- ◆Fire Safe Design and Construction
- ◆Investment Casting up to DN 150, Sand Casting for DN200
- ◆Anti-static Devices for Ball-stem-body
- ◆Blow-out Proof Stem
- ◆Pressure Balance Hole in Ball Slot
- ◆Double Stem Sealing to Comply with TA-LUFT Requirements
- ◆Casting Boss on Body for Draining and Double Block & Bleed

APPLICABLE STANDARDS

- ◆Design Rating: DIN3357/1,2, EN 12516-1
- ◆Fire Safe: API607 4th1993, BS 6755 Part 2
- ◆Face to Face: DIN 3202 F1 (DN15-DN100)/F7 (DN125-DN250)/F17, F4 (DN15-DN100)/F5 (DN125-DN250)/F18
- ◆Wall Thickness: ASME B16.34, EN12516-1
- ◆End Flange: DIN 2542-DIN2545, EN 1092
- ◆Inspection & Testing: DIN 3230/3, EN 12266
- ◆Connection: DIN 2501/1 PN10-PN40
- ◆Face: DIN 2562 FORM C

主要构件材料 Materials of Main Construction

No.	Part Name	Materials			
1	Body	CF8M	CF8		WCB
2	End Cap	CF8M	CF8		WCB
3	Ball	CF8M	CF8		
4	Ball Seat	PTFE			
5	Bolting	A193-B8		A193-B7	
6	Stem	SUS316		SUS304	
7	Anti-Static	SUS316		SUS304	
8	Stem Seal-Ring	PTFE/GRAFOIL*			
9	V-Ring Packing	PTFE/GRAFOIL*			
10	Bushing	50%SS+50%PTFE/SUS304*			
11	Gland	SUS304			
12	Belleville Washer	SUS301			
13	Stem Nut	SUS304			
14	Stop-lock-Cap	SUS304			
15	Handle Gland	SUS304			
16	Square Washer	SUS304			
17	Circle Washer	SUS304			
18	Screw	SUS304			
19	Handle sleeve(1/2"-3")	VINYL PLASTIC			
20	Handle(1/2"-3")	SUS304			
21	Lock Device(1/2"-3")	SUS304			
22	Body Gasket	PTFE/SUS316 SPIRAL WOUND/GRAFOIL*			
23	Stop Bolt	SUS304			
24	Set Screwed(4"-6")	SUS304			
25	Handle(4"-6")	SUS304			
26	Handle Adapter(4"-6")	SUS304			

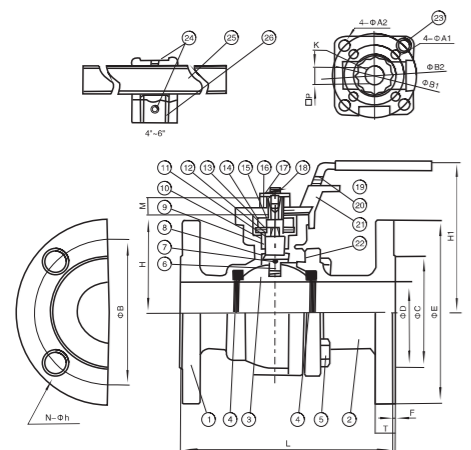

主要尺寸 Dimensions

Size	1/2"	3/4"	1"	1-1/4"	1-1/2"	2"	2-1/2"	3"	4"	5"	6"	8"
ΦD	15.0	20.0	25.0	32.0	38.0	50.0	64.0	76.0	100.0	125.0	150.0	200.0
L	108.0	117.0	127.0	140.0	165.0	178.0	190.0	203.0	229.0	356.0	394.0	457.0
ΦC	35.0	43.0	51.0	63.5	73.2	92.0	104.7	127.0	157.2	186.0	216.0	270.0
ΦE	89.0	98.6	108.0	117.0	127.0	152.5	177.8	190.5	228.6	254.0	279.4	342.9
ΦB	60.5	70.0	79.2	88.9	98.6	120.7	139.7	152.4	190.5	216.0	241.3	298.5
T	9.7	10.5	11.2	12.7	14.2	15.9	17.5	19.1	23.9	24.0	25.4	28.5
f	1.6	1.6	1.6	1.6	1.6	1.6	1.6	1.6	1.6	1.6	1.6	1.6
N	4.0	4.0	4.0	4.0	4.0	4.0	4.0	4.0	8.0	8.0	8.0	8.0
Φh	16.0	16.0	16.0	16.0	16.0	19.0	19.0	19.0	19.0	22.3	22.3	22.3
H	48.0	53.0	64.0	71.0	76.0	85.0	104.0	114.0	140.0	183.0	202.0	253.0
H1	79.0	84.0	95.0	103.0	111.0	120.0	153.0	163.0	182.0	260.0	28.0	non
K	7/16-24UNF	7/16-24UNF	9/16-18UNF	9/16-18UNF	5/8-18UNF	5/8-18UNF	7/8-14UNF	7/8-14UNF	1-1/8-12UNF	1-3/8-12UNF	1-3/8-12UNF	1-3/4-12UNF
P	9.0	9.0	11.0	11.0	14.0	14.0	17.0	17.0	22.0	27.0	27.0	27.0
A1	6.0	6.0	6.0	6.0	7.0	7.0	9.0	9.0	non	14.0	14.0	14.0
A2	6.0	6.0	7.0	7.0	9.0	9.0	11.0	11.0	11.0	non	non	non
B1	36.0	36.0	42.0	42.0	50.0	50.0	70.0	70.0	non	125.0	125.0	125.0
B2	42.0	42.0	50.0	50.0	70.0	70.0	102.0	102.0	102.0	non	non	non

HIGH MOUNTING PAD FLANGED BALL VALVE, DIN



DESIGN FEATURES

- ◆Built-in ISO 5211 Direct Mounting Pad for Easy Automation
- ◆Fire Safe Design and Construction
- ◆Investment Casting up to DN 150, Sand Casting for DN200
- ◆Anti-static Devices for Ball-stem-body
- ◆Blow-out Proof Stem
- ◆Pressure Balance Hole in Ball Slot
- ◆Double Stem Sealing to Comply with TA-LUFT Requirements
- ◆Casting Boss on Body for Draining and Double Block & Bleed

APPLICABLE STANDARDS

- ◆Design Rating: DIN3357/1,2, EN 12516-1
- ◆Fire Safe: API 607 4th 1993, BS 6755 Part 2
- ◆Face to Face: DIN 3202 F1 (DN15-DN100)/F7 (DN125-DN250)/F17, F4 (DN15-DN100)/F5 (DN125-DN250)/F18
- ◆Wall Thickness: ASME B16.34, EN12516-1
- ◆End Flange: DIN 2542-DIN2545, EN 1092
- ◆Inspection & Testing: DIN 3230/3, EN 12266
- ◆Connection: DIN 2501/1 PN10-PN40
- ◆Face: DIN 2562 FORM C

主要构件材料 Materials of Main Construction

No.	Part Name	Materials			
1	Body	CF8M	CF8		WCB
2	End Cap	CF8M	CF8		WCB
3	Ball	CF8M	CF8		
4	Ball Seat	PTFE			
5	Bolting	A193-B8		A193-B7	
6	Stem	SUS316		SUS304	
7	Anti-Static	SUS316		SUS304	
8	Stem Seal-Ring	PTFE/GRAFOIL*			
9	V-Ring Packing	PTFE/GRAFOIL*			
10	Bushing	50%SS+50%PTFE/SUS304*			
11	Gland	SUS304			
12	Belleville Washer	SUS301			
13	Stem Nut	SUS304			
14	Stop-lock-Cap	SUS304			
15	Handle Gland	SUS304			
16	Square Washer	SUS304			
17	Circle Washer	SUS304			
18	Screw	SUS304			
19	Handle sleeve(1/2"-3")	VINYL PLASTIC			
20	Handle(1/2"-3")	SUS304			
21	Lock Device(1/2"-3")	SUS304			
22	Body Gasket	PTFE/SUS316 SPIRAL WOUND/GRAFOIL*			
23	Stop Bolt	SUS304			
24	Set Screwed(4"-6")	SUS304			
25	Handle(4"-6")	SUS304			
26	Handle Adapter(4"-6")	SUS304			

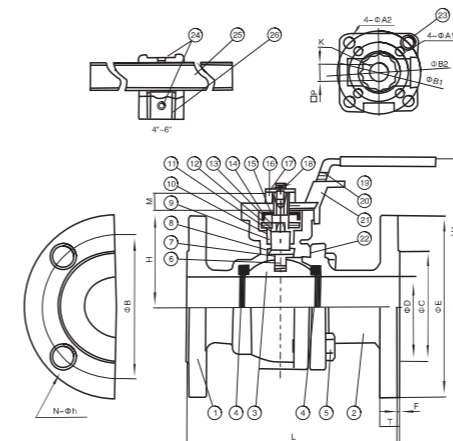

主要尺寸 Dimensions

Size	DN15	DN20	DN25	DN32	DN40	DN50	DN65	DN80	DN100	DN125	DN150	DN200
	1/2"	3/4"	1"	1-1/4"	1-1/2"	2"	2-1/2"	3"	4"	5"	6"	8"
PN	10	16	25	25	40		10/16	25/40	10/16	25/40	10/16	25/40
ΦD	15.0	20.0	25.0	32.0	38.0	50.0	64.0	76.0	100.0	125.0	150.0	200.0
L	115.0	120.0	125.0	130.0	140.0	150.0	170.0	180.0	190.0	325.0	350.0	400.0
*L	130.0	150.0	160.0	180.0	200.0	230.0	290.0	310.0	350.0	400.0	450.0	550.0
ΦC	45.0	58.0	68.0	78.0	88.0	102.0	122.0	138.0	158.0	155.0	212.0	250.0
ΦE	95.0	105.0	115.0	140.0	150.0	165.0	185.0	200.0	220.0	235.0	250.0	340.0
ΦB	65.0	75.0	85.0	100.0	110.0	125.0	145.0	160.0	180.0	190.0	210.0	280.0
f	2.0	2.0	2.0	2.0	3.0	3.0	3.0	3.0	3.0	3.0	3.0	3.0
T	16.0	18.0	18.0	18.0	18.0	20.0	18.0	22.0	20.0	24.0	22.0	26.0
N	4.0	4.0	4.0	4.0	4.0	4.0	4.0	8.0	8.0	8.0	8.0	8.0
Φh	14.0	14.0	14.0	14.0	18.0	18.0	18.0	18.0	18.0	22.0	22.0	26.0
H	48.0	53.0	64.0	71.0	76.0	85.0	104.0	114.0	140.0	185.0	212.0	250.0
H1	79.0	84.0	95.0	103.0	111.0	120.0	153.0	163.0	182.0	260.0	250.0	non
M	7.0	7.0	11.0	11.0	14.0	14.0	17.0	17.0	22.0	27.0	27.0	27.0
K	7/16-24UNF	7/16-24UNF	9/16-18UNF	9/16-18UNF	5/8-18UNF	5/8-18UNF	7/8-14UNF	7/8-14UNF	1-1/8-12UNF	1-3/8-12UNF	1-3/8-12UNF	1-3/4-12UNF
P	9.0	9.0	11.0	11.0	14.0	14.0	17.0	17.0	22.0	27.0	27.0	27.0
A1	6.0	6.0	6.0	6.0	7.0	7.0	9.0	9.0	non	14.0	14.0	14.0
A2	6.0	6.0	7.0	7.0	9.0	9.0	11.0	11.0	11.0	non	non	non
B1	36.0	36.0	42.0	42.0	50.0	50.0	70.0	70.0	non	125.0	125.0	125.0
B2	42.0	42.0	50.0	50.0	70.0	70.0	102.0	102.0	102.0	non	non	non

3-PC FLANGE BALL VALVE FULL PORT
ISO-DIRECT MOUNTING PAD

PRODUCTS STANDARD

- ◆Blow-Out Proof Stem 防脱出阀杆
- ◆Investment Casting Body 精密铸造阀体
- ◆Full Port 全通径设计
- ◆Face to Face:ANSI B16.10/JIS B2002/DINPN16-40
- ◆ISO5211 Direct Mounting Pad 直装型平台设计
- ◆Fire-Safe Design Available Acc:API 607 防火设计
- ◆Design Acc设计标准: ASME B16.34
- ◆Flange Standard:ASME 16.5/JIS B2220/DIN 2633
- ◆Inspection & Testing Acc 检测标准: API598
- ◆Seat:PTFE,Glass filled PTFE Carbon filled PTFE available

Pressure-Temperature Rating DN15~DN100

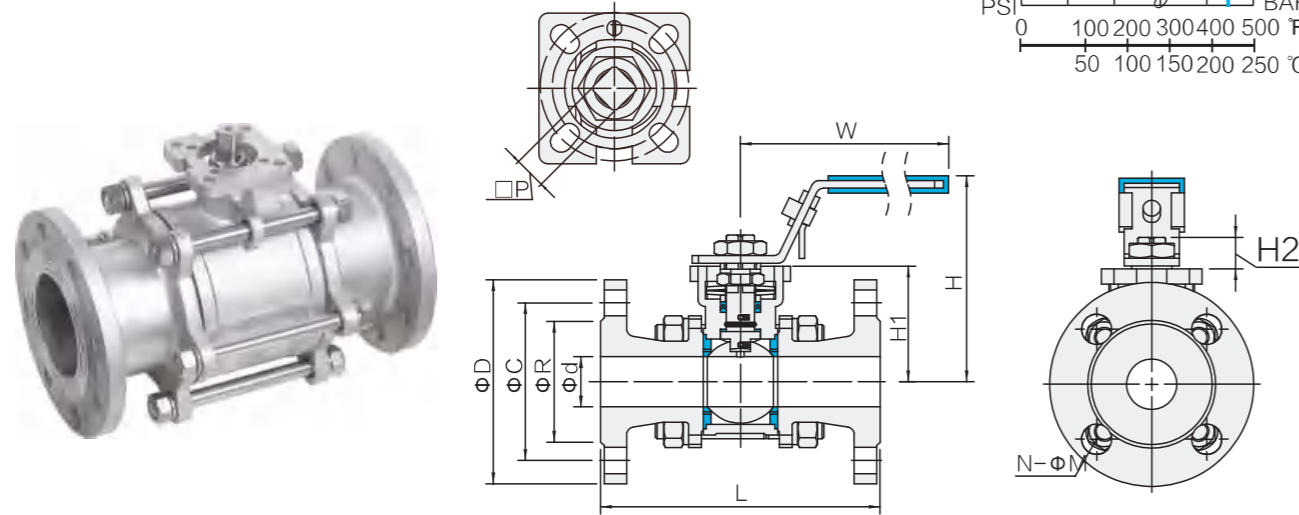
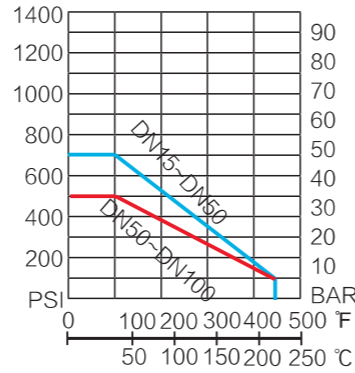

主要构件材料 Materials of Main Construction

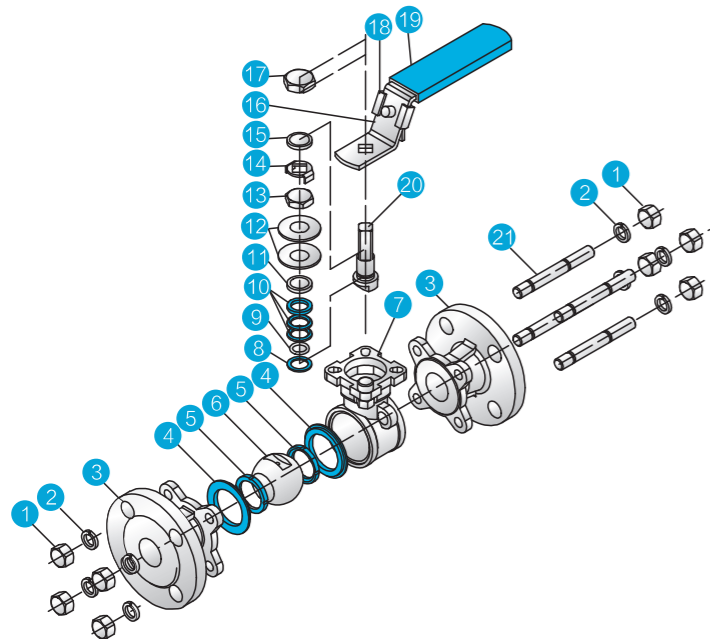

Item No.	Part Name	Material
1	Nut 螺母	SS304
2	Spring Washer 弹簧垫圈	SS304
3	Cap 阀盖	CF8M CF8 WCB
4	Body Gasket 垫圈	PTFE R-PTFE
5	Ball Seat 阀座	PTFE R-PTFE
6	Ball 球	SS316 SS304
7	Body 阀体	CF8M CF8 WCB
8	Thrust Washer 止推垫圈	PTFE
9	O-Ring O型圈	VITON
10	V-Ring Packing V型填料	PTFE
11	Gland 压套	SS304
12	Beleville Washer 蝶簧	SS304
13	Stop Nut 止推螺母	SS304
14	Stop Washer 止推垫圈	SS304
15	Washer 垫圈	SS304
16	Handle 手柄	SS304
17	Stem Nut 阀杆螺母	SS304
18	Locking Device 锁定装置	SS201
19	Handle Cover 手柄皮套	Plastic
20	Stem 阀杆	SS304
21	Bolt 螺栓	SS304

ANSI 150# unit:mm

Size	φd	L	H	H2	W	φR	φC	φD	□P	N-φM	T	F	Torque N.M	ISO 5211
1/2"	15	108	77	8	110	35	60.5	89	9	4-16	11.2	1.6	7	FC3 F04
3/4"	20	117	89	8	110	43	70	98	9	4-16	11.2	1.6	9	FC3 F04
1"	25	127	92	10	160	51	79.5	108	11	4-16	12.0	1.6	11	FC4 F05
1-1/4"	32	140	97	10	160	64	89	117	11	4-16	12.7	1.6	18	FC4 F05
1-1/2"	38	165	111	14	185	73	98.5	127	14	4-16	14.3	1.6	23	F05 F07
2"	50	178	120	14	185	92	120.5	152	14	4-19	15.9	1.6	28	F05 F07
2-1/2"	65	190	145	18	250	105	139.5	178	17	4-19	17.5	1.6	55	FC7 F10
3"	78	203	156	18	280	127	152.5	190.5	17	4-19	19.1	1.6	90	FC7 F10
4"	100	229	168	18	310	157	190.5	229	19	8-19	23.9	1.6	120	FC7 F10

JIS 10K unit:mm

Size	φd	L	H	H2	W	φR	φC	φD	□P	N-φM	T	F	Torque N.M	ISO 5211
1/2"	15	108	77	8	110	51	70	95	9	4-15	12	1	7	F03/FC4
3/4"	20	114	89	8	110	56	75	100	9	4-15	14	1	9	F03/FC4
1"	25	127	92	10	160	67	90	125	11	4-19	14	1	11	F04/FC5
1-1/4"	32	140	97	10	160	76	100	135	11	4-19	16	2	18	F04/FC5
1-1/2"	38	165	111	14	185	81	105	140	14	4-19	16	2	23	F05/FC7
2"	50	178	120	14	185	96	120	155	14	4-19	16	2	25	F05/FC7
2-1/2"	65	190	145	18	250	116	140	175	17	4-19	18	2	55	F07/F10
3"	78	203	156	18	280	126	150	185	17	8-19	18	2	90	F07/F10
4"	100	229	168	18	310	151	175	210	19	8-19	18	2	120	F07/F10

DIN PN16 unit:mm

Size	φd	L	H	H2	W	φR	φC	φD	□P	N-φM	T	F	TORQUE N.M	ISO 5211
1/2"	15	130	77	8	110	45	65	95	9	4-14	14	2	7	F03/FC4
3/4"	20	150	89	8	110	58	75	105	9	4-14	16	2	9	F03/FC4
1"	25	160	92	10	160	68	85	115	11	4-14	16	2	11	F04/FC5
1-1/4"	32	180	97	10	160	78	100	140	11	4-18	16	2	18	F04/FC5
1-1/2"	38	200	111	14	185	88	110	150	14	4-18	16	3	23	F05/FC7
2"	50	230	120	14	185	102	125	165	14	4-18	18	3	25	F05/FC7
2-1/2"	65	290	145	18	250	122	145	185	17	4-18	18	3	55	F07/F10
3"	78	310	156	18	280	138	160	200	17	8-18	20	3	90	F07/F10
4"	100	350	168	18	310	158	180	220	19	8-18	20	3	120	F07/F10

FLANGED BALL VALVE, GB/T

主要构件材料 Materials of Main Construction

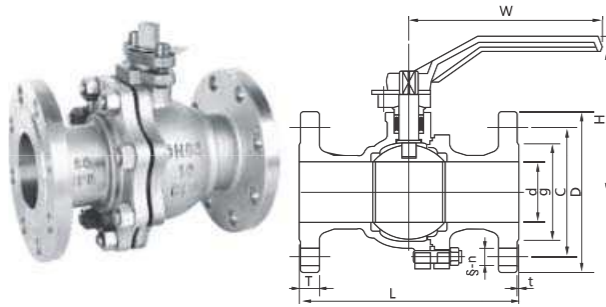

序号 No.	部件 Part Name	材料 Material
1	阀体 Body	304/316
2	阀盖 Bonnet	304/316
3	阀座 Ball Seat	PTFE
4	球 Ball	304/316
5	大薄片 Gasket	PTFE
6	小薄片 Thrust Washer	PTFE
7	阀杆 Stem	304/316
8	填料 Packing	PTFE
9	压套 Gland	304
10	压板 Gland Flange	304
11	定位片 Lock Plate	304
12	轴用挡圈 Retainer Ring	304
13	手柄 Handle	Cast Iron 铸铁
14	双头螺栓 Bonnet Bolt	304
15	螺母 Nut	304
16	内六角螺栓 Bonnet Bolt	304

执行标准 Compliance Standard

设计 Design	GB/T 12237
压力温度基准 Pressure-Temperature Rating	GB/T 12224
结构长度 Face to Face	GB/T 12221
法兰尺寸 Flange Dimensions	JB/T 79.1-1994, GB/T 9113.1
检验和测试 Inspection & Testing	JB/T 9092
主体材料 Body Material	GB/T 12230-ZG08Cr18Ni9; ZG08Cr18Ni12Mo2Ti; ZG03Cr18Ni10; ZG12Cr18Ni12Mo2Ti; A216-WCB

主要尺寸 Dimensions

Unit:mm

公称压力 Nominal pressure	Size Dimensions													
	DN	d	L(JB)	L(GB)	D(JB)	D(GB)	C	g	T	t	H	w	n-φ	
PN1.6 Mpa	15	15	108	130	95	95	65	46	14	2	60	108	4-14	
	20	20	117	130	105	105	75	56	16	2	64	120	4-14	
	25	25	127	140	115	115	85	65	16	2	90	165	4-14	
	32	32	140	165	135	140	100	76	18	2	105	180	4-18	
	40	40	165	165	145	150	110	84	18	2	150	240	4-18	
	50	50	178	203	160	165	125	99	20	2	190	240	4-18	
	65	65	190	222	180	185	145	118	20	2	195	320	4-18	
	80	80	203	241	195	200	160	132	20	2	215	350	8-18	
	100	100	305	305	215	220	180	156	22	2	250	400	8-18	
	125	125	356	-	250	-	210	184	22	2	-	-	8-18	
	150	150	394	-	285	-	240	211	24	2	-	-	8-22	
	200	200	457	-	340	-	295	266	24	2	-	-	12-22	
250	250	533	-	405	-	355	319	26	2	-	-	12-26		
300	300	610	-	460	-	410	370	28	2	-	-	12-26		
350	350	686	-	520	-	470	435	34	2	-	-	16-25		

SCREW END GATE VALVE

200WOG

PRODUCTS STANDARD

- ◆Investment: Casting Body 精密铸造阀体
- ◆200 WOG
- ◆Metal to Metal Seal 金属密封阀座
- ◆Wheel Handle 手轮操作
- ◆Screw End Standard: DN2000/BSP/NPT ISO228-1/BS21
- ◆Design Acc 设计标准: ASME B16.34
- ◆Inspection & Testing Acc 检验标准: AP 598

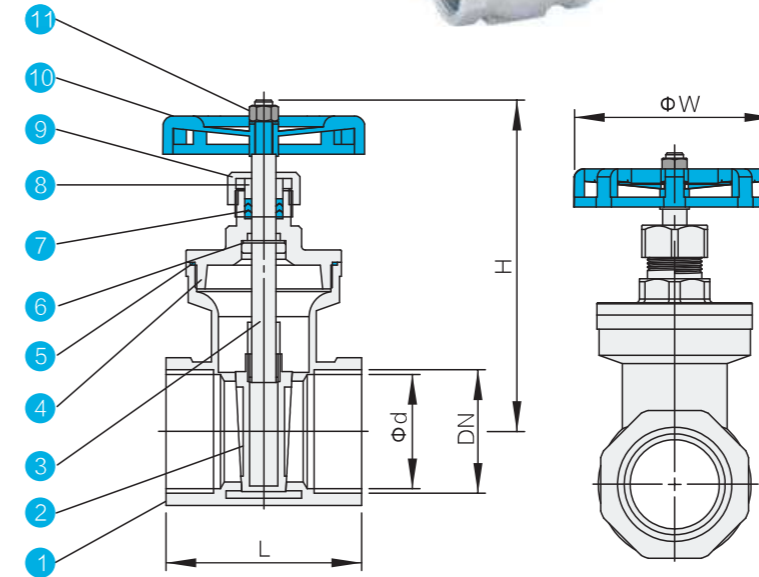

主要构件材料 Materials of Main Construction

Item No.	Part Name	Material
1	Body 阀体	CF8M / CF8
2	Disc 闸板	CF8M / CF8
3	Stem 阀杆	SS316 / SS304
4	Bonnet 压盖	CF8M / CF8
5	Gasket 垫圈	PTFE
6	Gasket 垫片	PTFE
7	Stem Packing 阀杆密封	PTFE
8	Gland 压套	SS316 / SS304
9	Gland Flange 压盖	CF8M / CF8
10	Handle 手轮	Cast Iron
11	Name Plate 标牌	Aluminum 铝
12	Nut 螺母	SS304

主要尺寸 Dimensions

Unit:mm

Size		L	d	H	W
NPS	DN				
1/2"	15	55	15	99	70
3/4"	20	60	20	105	70
1"	25	66	25	115	80
1-1/4"	32	76	32	130	90
1-1/2"	40	80	40	147	90
2"	50	90	50	168	100
2-1/2"	65	112	65	213	140
3"	80	122	80	241	140
4"	100	130	99	340	160

FLANGE GATE VALVE, ASME



PRODUCTS STANDARD

- ◆Investment Casting Body 精密铸造阀体
- ◆ANSI 150# 300# 美标150# 300#
- ◆Metal to Metal Sealing 金属密封阀座
- ◆Wheel Handle 手轮操作
- ◆Casting Handle 铸造手柄
- ◆Flange Standard 法兰标准: ASME B16.5
- ◆Design Acc 设计标准: ASME B16.34
- ◆Inspection & Testing Acc 检测标准: API598

主要构件材料 Materials of Main Construction

Item No.	Part Name	Material
1	Body 阀体	CF8M CF8 WCB
2	Seat 阀座	CF8M CF8 WCB
3	Disc 阀瓣	CF8M CF8 WCB
4	Stem 阀杆	SS316 SS304 F6A
5	Nut 螺母	SS304
6	Gasket 密封圈	SS304+Graphite /PTFE
7	Bolt 螺栓	SS304
8	Nut 螺母	SS04
9	Seal 密封圈	SS316 SS304 F6A
10	Bonnet 阀盖	CF8M CF8 WCB
11	Stem Packing 阀杆密封	Graphite/PTFE
12	Gland 压套	CF8 WCB
13	Eye Bolt 紧定螺栓	A193-B7
14	Gland Flange 压盖	CF8 WCB
15	Nut 螺母	SS304
16	Sleeve 压套	Bronze
17	Stop Nut 紧定螺母	SS304 A105
18	Handle 手轮	Cast steel
19	Stem Nut 阀杆螺母	SS304 A105
20	Grease nipple 放油孔	Brass

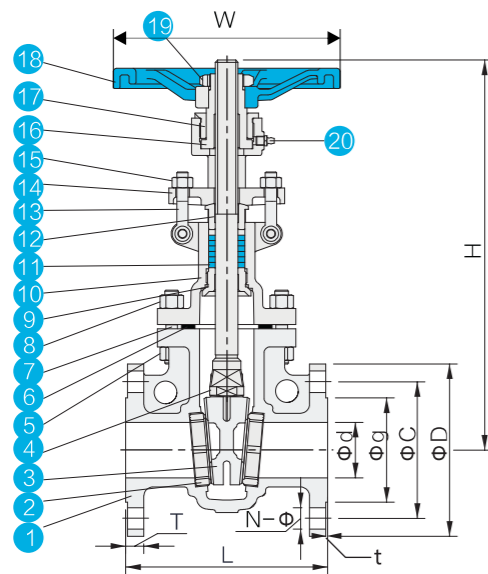

主要尺寸 Dimensions

Unit:mm

公称压力 Nominal pressure	Size	Dimensions									
		in	d	L	D	C	g	T	t	H	W
Class 150Lb	1-1/4"	32	140	117	89	64	13	1.6	252	100	4-1.5
	1-1/2"	40	165	127	98.5	73	15	1.6	277	110	4-1.5
	2"	50	178	152	120.5	92	16	1.6	323	200	4-1.9
	2-1/2"	65	190	178	139.5	105	18	1.6	347	250	4-1.9
	3"	80	203	190	152.5	127	19	1.6	383	250	4-1.9
	4"	100	229	229	190.5	157	24	1.6	457	300	8-1.9
	5"	125	254	254	216	186	24	1.6	632	300	8-2.2
	6"	150	267	279	241.5	216	26	1.6	635	350	8-2.2
	8"	200	292	343	298.5	270	29	1.6	762	350	8-2.2
	10"	250	330	406	362	324	31	1.6	895	400	12-2.5
	12"	300	356	483	432	381	32	1.6	1020	500	12-2.5
	14"	350	381	533	476	413	35	1.6	1295	600	12-2.9
	16"	400	406	597	540	470	37	1.6	1435	600	16-2.9
	18"	450	432	635	578	533	40	1.6	1626	650	16-3.2
20"	500	457	698	635	584	43	1.6	1829	650	20-3.2	
24"	600	508	813	749.5	692	48	1.6	2175	700	20-3.5	
Class 300Lb	1-1/4"	32	178	133	98.5	63	19	1.6	215	160	4-1.9
	1-1/2"	40	190	156	114.5	73	21	1.6	250	160	4-2.2
	2"	50	216	165	127	92	22	1.6	330	250	8-1.9
	2-1/2"	65	241	190	149	105	25	1.6	368	250	8-2.2
	3"	80	283	210	168	127	29	1.6	394	300	8-2.2
	4"	100	305	254	200	157	32	1.6	473	300	8-2.2
	5"	125	381	279	235	186	35	1.6	660	350	8-2.2
	6"	150	403	318	270	216	37	1.6	711	350	12-2.2
	8"	200	419	381	330	270	41	1.6	813	400	12-2.5
	10"	250	457	444	387.5	324	48	1.6	1003	500	16-2.9
	12"	300	502	521	451	381	51	1.6	1137	500	16-3.2
	14"	350	762	584	514.5	413	54	1.6	1429	600	20-3.2
	16"	400	838	648	571.5	470	57	1.6	1521	650	20-3.5
	18"	450	914	711	628.5	533	60	1.6	2017	838	24-3.5
20"	500	991	775	686	584	64	1.6	2228	839	24-3.5	
24"	600	1143	914	813	692	70	1.6	2550	1092	24-4.1	

FLANGED GATE VALVE, GB/T

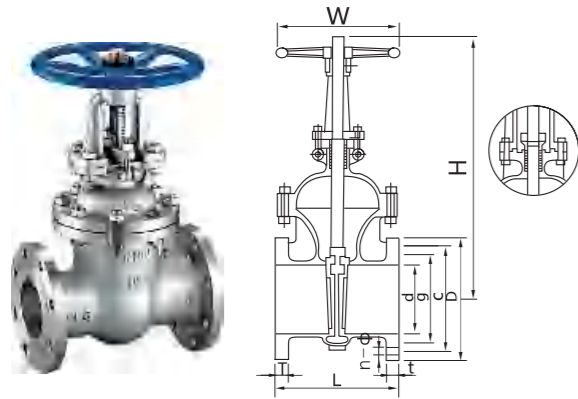

主要构件材料 Materials of Main Construction

序号 No.	部件 Part Name	材料 Material
1	阀体 Body	WCB/304/316
2	闸板 Disc	WCB/304/316
3	阀杆 Stem	F6/304/316
4	大薄片 Gasket	PTFE/不锈钢+PTFE缠绕
5	阀盖 Bonnet	F6/304/316
6	填料 Packing	PTFE/柔性石墨
7	压套 Gland	F6/304
8	压板 Gland Flange	WCB/304
9	阀杆螺母 Stem Nut	A439-D2
10	手轮 Handwheel	QT400-15
11	铭牌 Nameplate	Aluminum (铝)
12	手轮螺母 Handwheel Nut	35Crmo
13	中法兰螺母 Nut	A194-8
14	中法兰螺栓 Bonnet Bolt	A193-B8
15	销轴 Eyebolt Pin	06Cr19Ni10
16	活节螺栓 Eyebolt	A193-B8
17	活节螺母 Nut	A194-8

执行标准 Compliance Standard

设计 Design	GB/T 12234
压力温度基准 Pressure-Temperature Rating	GB/T 12224
结构长度 Face to Face	GB/T 12221
法兰尺寸 Flange Dimensions	GB/T9113.1
检验和测试 Inspection & Testing	JB/T 9092
主体材料 Body Material	GB/T 12230-ZG08Cr18Ni9; ZG08Cr18Ni12MoTi; ZG03Cr18Ni10; ZG12Cr18Ni12MoTi

主要尺寸 Dimensions

Unit:mm

公称压力 Nominal pressure	Size		Dimensions									
	DN	d	L	D(1)	D(2)	C	g	T	t	H	w	n-φ
PN1.6 Mpa	15	15	130	95	95	65	46	14	2	170	120	4-14
	20	20	150	105	105	75	56	16	2	190	140	4-14
	25	25	160	115	115	85	65	16	2	205	160	4-14
	32	32	180	135	140	100	78	16	2	270	180	4-18
	40	40	200	145	150	110	84	18	2	310	200	4-18
	50	50	250	160	165	125	99	20	2	358	240	4-18
	65	65	265	180	185	145	118	20	2	373	240	4-18
	80	80	280	195	200	160	132	20	2	435	280	8-18
	100	100	300	215	220	180	156	22	2	500	300	8-18
	125	125	325	245	250	210	184	22	2	614	320	8-18
	150	150	350	280	285	240	211	24	2	674	360	8-22
	200	200	400	335	340	295	266	24	2	818	400	12-22
	250	250	450	405	405	355	319	26	2	969	450	12-26
	300	300	500	460	460	410	370	28	2	1145	560	12-26
	350	350	550	520	-	470	435	34	4	1280	640	16-25
	400	400	600	580	-	525	485	36	4	1452	640	16-30
	450	450	650	640	-	585	545	40	4	1541	720	20-30
500	500	700	705	-	650	608	44	4	1678	720	20-34	
600	600	800	840	-	770	718	48	5	1874	800	20-41	
700	700	900	910	-	840	788	50	5	-	-	24-41	
800	800	1000	1020	-	950	898	52	5	-	-	24-41	
900	900	1100	1120	-	1050	998	54	5	-	-	28-41	
1000	1000	1200	1255	-	1170	110	56	5	-	-	28-48	

主要尺寸 Dimensions

Unit:mm

公称压力 Nominal pressure	Size		Dimensions									
	DN	L	D(1)	D(2)	C	g	T	t	H	w	n-φ	
PN2.5 Mpa	15	130	95	95	65	46	14	2	170	120	4-14	
	20	150	105	105	75	56	16	2	190	140	4-14	
	25	160	115	115	85	65	16	2	205	160	4-14	
	32	180	135	140	100	78	16	2	270	180	4-18	
	40	200	145	150	110	84	18	2	310	200	4-18	
	50	250	160	165	125	99	20	2	358	240	4-18	
	65	265	180	185	145	118	22	2	373	240	8-18	
	80	280	195	200	160	132	24	2	435	280	8-18	
	100	300	230	235	190	156	24	2	500	300	8-22	
	125	325	270	270	220	184	26	2	614	320	8-26	
	150	350	300	300	250	211	28	2	674	360	8-26	
	200	400	360	360	310	274	30	2	818	400	12-26	
	250	450	425	425	370	330	32	2	969	450	12-30	
	300	500	485	485	430	389	34	2	1145	560	16-30	
	350	550	550	-	490	448	44	4	1290	640	16-34	
	400	600	610	-	550	505	48	4	1452	640	16-34	
	450	650	660	-	600	555	50	4	1541	720	20-34	
500	700	730	-	660	610	52	4	1678	720	20-41		
600	800	840	-	770	718	56	5	1874	800	20-41		
700	900	955	-	875	815	60	5	-	-	24-48		
800	1000	1070	-	990	930	64	5	-	-	24-48		
PN4.0 Mpa	50	250	160	-	125	100	20	3	371	230	4-18	
	65	280	180	-	145	120	22	3	391	230	8-18	
	80	310	195	-	160	135	22	3	455	320	8-18	
	100	350	230	-	190	160	24	3	551	350	8-22	
	125	400	270	-	220	188	28	3	628	400	8-25	
	150	450	300	-	250	218	30	3	708	400	8-25	
	200	550	375	-	320	282	38	3	835	450	12-30	
	250	650	445	-	385	345	42	3	906	550	12-34	
	300	750	510	-	450	408	46	4	1203	640	16-34	
	350	850	570	-	510	465	52	4	1341	640	16-34	
	400	950	655	-	585	535	58	4	1492	720	16-41	
	500	1150	755	-	670	612	62	4	-	-	20-48	
	600	1350	890	-	795	730	62	5	-	-	20-54	
	700	1450	995	-	900	835	68	5	-	-	24-54	
	800	1650	1135	-	1030	960	76	5	-	-	24-58	

SCREW END GLOBE VALVE
200WOG



- PRODUCTS STANDARD
- ◆Investment Casting Body 精密铸造阀体
 - ◆Full Port 全通径设计
 - ◆200WOG 压力等级
 - ◆Design Acc 设计标准: ASME B16.34
 - ◆Inspection & Testing Acc 检测标准: API598
 - ◆Screw End Standard: DIN2999/BSP/NPT
ISO228-1/BS21
 - ◆Other size on application

主要构件材料 Materials of Main Construction

Item No.	Part Name	Material	
1	Body 阀体	CF8M	CF8
2	Disc 闸瓣	CF8M	CF8
3	Stem 阀杆	SS316	SS304
4	Bonnet 阀盖	CF8M	CF8
5	Body Gasket 垫圈	PTFE	
6	Washer 垫圈	SS304	
7	Packing 填料	PTFE	
8	Packing Sleeve 垫圈	SS304	
9	Gland 压套	SS304	
10	Hand Wheel 手轮	Cast Iron	
11	Plain Washer 垫圈	SS304	
12	Nut 螺母	SS304	

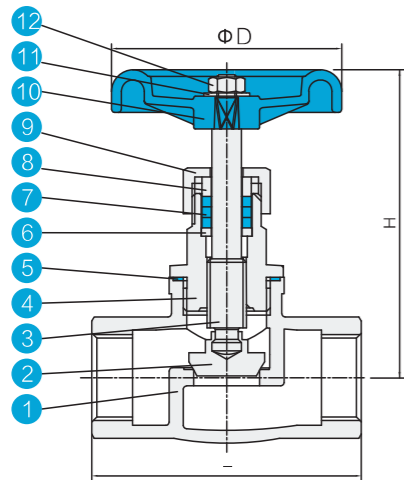

主要尺寸 Dimensions

Unit:mm

Size	1/4"	3/8"	1/2"	3/4"	1"	1-1/4"	1-1/2"	2"
L	65	65	70	80	90	105	120	140
H	93	93	93	97	112	124	137	149
D	65	65	65	65	72	96	105	105

FLANGE GLOBE VALVE, ASME



- PRODUCTS STANDARD
- ◆Investment Casting Body 精密铸造阀体
 - ◆ANSI 150#300# 美标 50#300#
 - ◆Metal to Metal Sealing 金属密封阀座
 - ◆Wheel Handle 手轮
 - ◆Casting Hand 铸造手柄
 - ◆Flange Standard 法兰标准: ASME B16.5
 - ◆Design Acc 设计标准: ASME B16.34
 - ◆Inspection & Testing Acc 检测标准: API598

主要构件材料 Materials of Main Construction

Item No.	Part Name	Material	
1	Body 阀体	CF8M	CF8 / WCB
2	Disc 阀瓣	CF8M	CF8 / WCB
3	Cover 阀盖盖	CF8M	CF8 / WCB
4	Bolt 螺栓	SS304	
5	Gasket 垫圈	PTFE	
6	Nut 螺母	SS304	
7	Eye Bolt 吊钩	SS304	
8	Nut 螺母	SS304	
9	Stem 阀杆	SS316	SS304 / F420
10	Wheel Handle 手轮	CAST IRON	
11	Stem Nut 阀杆螺母	SS304	
12	Bonnet 阀盖	CF8M	CF8 / WCB
13	Gland 压套	CF8	
14	Stem Packing 填料	PTFE	
15	Gland 压套	SS316	SS304
16	Nut 螺母	SS304	
17	Bolt 螺栓	SS304	

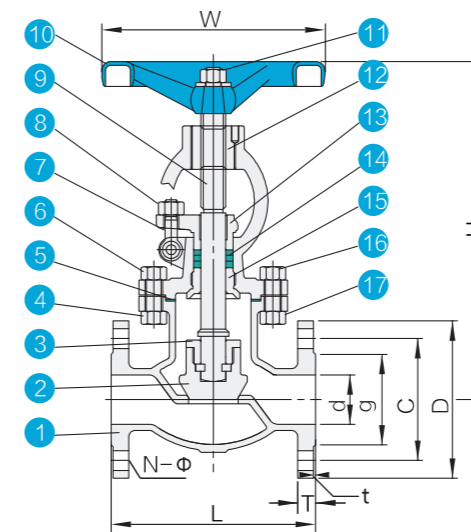

主要尺寸 Dimensions

Unit:mm

公称压力 Nominal pressure	Size	Dimensions									
		in	d	L	D	C	g	T	t	H	W
Class 150Lb	1-1/4"	32	140	117	89	64	13	1.6	252	100	4-15
	1-1/2"	40	165	127	98.5	73	15	1.6	277	140	4-15
	2"	50	178	152	120.5	92	16	1.6	323	200	4-19
	2-1/2"	65	190	178	139.5	105	18	1.6	347	250	4-19
	3"	80	203	190	152.5	127	19	1.6	383	250	4-19
	4"	100	229	229	190.5	157	24	1.6	457	300	8-19
	5"	125	254	254	216	186	24	1.6	632	300	8-22
	6"	150	267	279	241.5	216	26	1.6	635	350	8-22
	8"	200	292	343	298.5	270	29	1.6	762	350	8-22
	10"	250	330	406	362	324	31	1.6	895	400	12-25
	12"	300	356	483	432	381	32	1.6	1080	500	12-25

主要尺寸 Dimensions

Unit:mm

公称压力 Nominal pressure	Size	Dimensions									
	in	d	L	D	C	g	T	t	H	w	n-φ
300Lb	1/2"	15	152	95	66.5	35	15	1.6	211	125	4-15
	3/4"	20	178	117	82.5	43	16	1.6	241	125	4-19
	1"	25	203	124	89	51	18	1.6	283	160	4-19
	1-1/4"	32	216	133	98.5	63	19	1.6	320	200	4-19
	1-1/2"	40	229	156	114.5	73	21	1.6	322	200	4-22
	2"	50	267	165	127	92	22	1.6	399	200	8-19
	2-1/2"	65	292	190	149	105	25	1.6	438	250	8-22
	3"	80	318	210	168	127	29	1.6	450	280	8-22
	4"	100	356	254	200	157	32	1.6	584	355	8-22
	5"	125	400	279	235	186	35	1.6	614	355	8-22
	6"	150	444	318	270	216	37	1.6	660	450	12-22
	8"	200	559	381	330	270	41	1.6	762	450	12-25
	10"	250	622	444	387.5	324	48	1.6	850	500	16-29
	12"	300	711	521	451	381	51	1.6	1085	500	16-32
	14"	350	762	584	514.5	413	54	1.6	1187	600	20-32
	16"	400	864	648	571.5	470	57	1.6	1450	600	20-35

FLANGED GLOBE VALVE, GB/T

主要构件材料 Materials of Main Construction

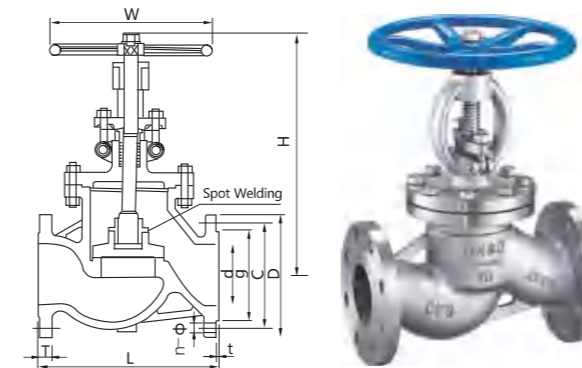

执行标准 Compliance Standard

设计 Design	GB/T 12235
压力温度基准 Pressure-Temperature Rating	GB/T 12224
结构长度 Face to Face	GB/T 12221
法兰尺寸 Flange Dimensions	JB/T 79-1994; GB/T 9113.1
检验和测试 Inspection & Testing	JB/T 9092
主体材料 Body Material	GB/T 12230-ZG08Cr18Ni9; ZG08Cr18Ni12Mo2Ti; ZG03Cr18Ni10; ZG12Cr18Ni12MoTi; A216-WCB

序号 No.	部件 Part Name	材料 Material
1	阀体 Body	ZG08Cr18Ni12Mo2Ti
2	阀瓣 Disc	ZG08Cr18Ni12Mo2Ti
3	阀瓣盖 Disc Cap	ZG08Cr18Ni12Mo2Ti
4	阀杆 Stem	C6Cr17Ni12Mo2
5	大薄片 Gasket	PTFE/不锈钢-PTFE缠绕
6	阀盖 Bonnet	ZG08Cr18Ni12Mo2Ti
7	填料 Packing	PTFE/柔性石墨
8	压套 Gland	C6Cr17Ni12Mo2
9	压板 Gland Flange	ZG08Cr18Ni12Mo2Ti
10	阀杆螺母 Stem Nut	A4-38-D2
11	手轮 Handwheel	QT400-15
12	铭牌 Nameplate	Aluminum(铝)
13	手轮螺母 Handwheel Nut	A194-8
14	中法兰螺母 Nut	A194-8
15	中法兰螺栓 Bonnet Bolt	A193-B8
16	销轴 Eyebolt Pin	C6Cr18Ni10
17	活节螺栓 Eyebolt	A193-B8
18	活节螺母 Nut	A194-8

主要尺寸 Dimensions

Unit:mm

公称压力 Nominal pressure	Size	Dimensions									
	DN	L	D(1)	D(2)	C	g	T	t	H	w	n-φ
PN1.6 Mpa	15	130	95	95	65	46	14	2	218	120	4-14
	20	150	105	105	75	56	16	2	253	140	4-14
	25	160	115	115	85	65	16	2	275	160	4-14
	32	180	135	135	100	78	16	2	282	180	4-18
	40	200	145	150	110	84	18	2	330	200	4-18
	50	230	160	165	125	99	20	2	350	240	4-18
	65	290	180	185	145	118	20	2	400	280	4-18
	80	310	195	200	160	132	20	2	355	280	8-18
	100	350	215	220	180	156	22	2	415	320	8-18
	125	400	245	250	210	184	22	2	460	360	8-18
	150	480	280	285	240	211	24	2	510	400	8-22
	200	600	335	340	295	266	24	2	710	400	12-22
	250	650	405	405	355	319	26	2	785	450	12-26
	300	750	460	460	410	370	28	2	925	500	12-26
	350	850	520	520	470	435	34	2	1075	700	16-25
	400	950	580	580	525	485	36	2	1235	800	16-30
450	1200	640	640	585	545	40	2	-	1000	20-30	
500	1250	705	705	650	608	44	2	-	1000	20-34	

主要尺寸 Dimensions

Unit:mm

公称压力 Nominal pressure	Size DN	Dimensions									
		L	D(1)	D(2)	C	g	T	t	H	w	n-φ
PN2.5 Mpa	15	130	95	95	65	45	16	2	218	120	4-14
	20	150	105	105	75	55	16	2	260	140	4-14
	25	160	115	115	85	65	16	2	275	160	4-14
	32	180	135	135	100	78	18	2	282	180	4-18
	40	200	145	150	110	85	18	3	332	200	4-18
	50	230	160	165	125	99	20	3	350	240	4-18
	65	290	180	185	145	120	22	3	405	280	8-18
	80	310	195	200	160	135	22	3	360	280	8-18
	100	350	230	235	190	160	24	3	412	320	8-23
	125	400	270	275	220	188	28	3	462	360	8-25
	150	480	300	305	250	218	30	3	510	400	8-25
	200	600	360	365	310	278	34	3	715	400	12-25
	250	650	425	430	370	322	36	3	789	450	12-30
	300	750	485	490	430	390	40	4	925	500	12-30
	350	850	550	555	490	448	44	4	1025	700	16-34
	400	950	610	615	550	505	48	4	1235	800	16-34
450	1200	660	665	600	555	50	4	-	1000	20-34	
500	1250	730	735	660	610	52	4	-	1000	20-41	
PN4.0 Mpa	15	130	95	95	65	46	14	2	233	120	4-14
	20	150	105	105	75	56	16	2	275	140	4-14
	25	160	115	115	85	65	16	2	285	160	4-14
	32	180	135	140	100	78	18	2	305	180	4-18
	40	200	145	150	110	84	18	3	355	200	4-18
	50	230	160	165	125	99	20	3	373	240	4-18
	65	290	180	185	145	118	22	3	408	280	8-18
	80	310	195	200	160	132	24	3	436	320	8-18
100	350	230	235	190	156	24	3	480	360	8-22	
125	400	270	270	220	154	26	3	558	400	8-26	
150	480	300	300	250	211	28	3	611	400	8-26	
200	600	375	375	320	284	34	3	720	400	12-30	

SCREW SWING CHECK VALVE
200WOG

PRODUCTS STANDARD

- ◆Investment Casting Body 精密铸造阀体
- ◆Full Port 全通径设计
- ◆200WOG 压力等级
- ◆Design Acc设计标准: ASME B16.34
- ◆Inspection & Testing Acc检测标准: API598
- ◆Screw End Standard:DIN21/BSP/NPT
ISO7-1/BS21



主要构件材料 Materials of Main Construction

Item No.	Part Name	Material	
1	Body 阀体	CF8M	CF8
2	Disc 闸板	CF8M	CF8
3	Cap 阀盖	SS316	SS304
4	Gasket 密封垫	CF8M	CF8
5	Pin 插销	304	
6	Plain Washer 垫圈	SS304	
7	Bolt 螺栓	304	

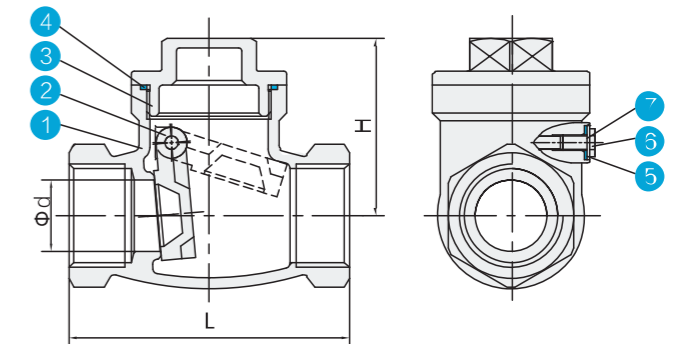

主要尺寸 Dimensions

Unit:mm

Size	1/4"	3/8"	1/2"	3/4"	1"	1-1/4"	1-1/2"	2"	2-1/2"	3"
L	56	56	62.4	74.5	85	101	115.1	134.5	154	191
H	36.5	36.5	40	49.5	57	61.5	71	77	139	158
d	10	10	15	20	23	30	38	47	67	81

Y-TYPE CHECK VALVE
800WOG

PRODUCTS STANDARD

- ◆Investment Casting Body 精密铸造阀体
- ◆800WOG 压力等级
- ◆Design Acc设计标准: ASME B16.34
- ◆Screw End Standard: DIN2999/BSP/NPT ISO7-1/BS21
- ◆Inspection & Testing Acc检测标准: API598



主要构件材料 Materials of Main Construction

Item No.	Part Name	Material	
1	Body 阀体	CF8M	CF8
2	Gasket 密封垫	SS304	
3	Seat 阀座	PTFE	
4	Bolt 螺栓	SS304	
5	Disc 阀瓣	CF8M	CF8
6	Spring 弹簧	SS316	SS304
7	Cap 阀盖	CF8M	CF8
8	Gasket 密封圈	PTFE	

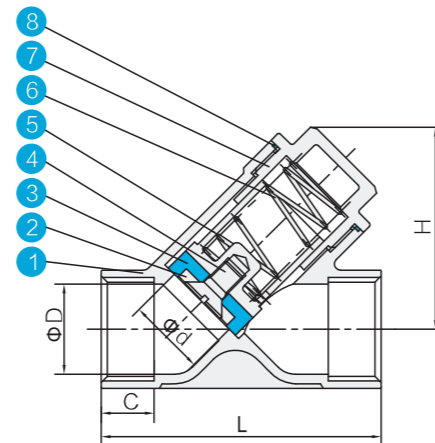

主要尺寸 Dimensions

Unit:mm

Size	1/2"	3/4"	1"	1-1/4"	1-1/2"	2"	2-1/2"	3"	4"
d	15	20	25	32	38	48	65	80	100
H	44.7	52.1	65.7	70	79.5	95.5	125.5	155	205
C	14	15	17	19	19	22	25	27	35
L	60	80	85	104	108	126	170	180	210

VERTICAL CHECK VALVE

PRODUCTS STANDARD

- ◆Investment Casting Body 精密铸造阀体
- ◆1000WOG压力等级
- ◆Metal to Metal Sealing 金属密封
- ◆Design Acc设计标准: ASME B16.34
- ◆Screw End Standard: DIN2999/BSP/NPT ISO7-1/BS21
- ◆Inspection & Testing Acc检测标准: API598



主要构件材料 Materials of Main Construction

Item No.	Part Name	Material	
1	Cap 阀盖	CF8M	CF8
2	Gasket 垫圈	PTFE	
3	Disc 阀瓣	SS316	SS304
4	Spring 弹簧	316	304
5	Body 阀体	CF8M/CF8	

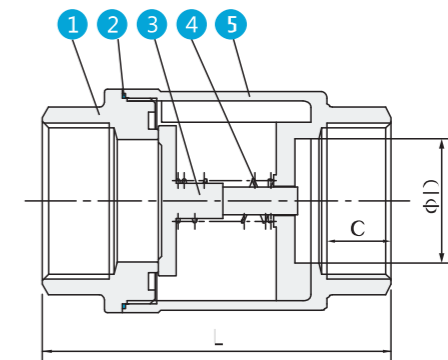

主要尺寸 Dimensions

Unit:mm

Size	1/4"	3/8"	1/2"	3/4"	1"	1-1/4"	1-1/2"	2"	2-1/2"	3"	4"
D	10	10	14	18	23	28	39	47	63	76	97
L	55	55	60	69.5	82	87	100	119	150	170	168
C	10	10	11	13	12	13	18	19.5	25	29	39

FLANGED SWING CHECK VALVE, GB/T

主要构件材料 Materials of Main Construction

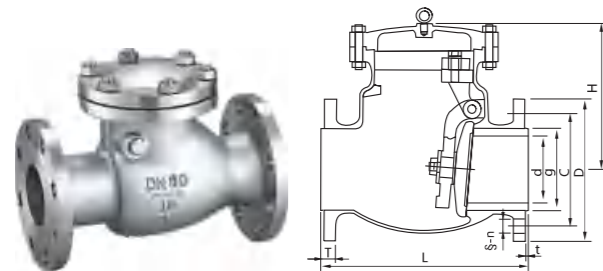

序号 No.	部件 Part name	材料 Material
1	阀体 Body	ZG08Cr18Ni12MO2Ti
2	阀瓣 Disc	ZG08Cr18Ni12MO2Ti
3	摇杆 Hinge	ZG08Cr18Ni12MO2Ti
4	垫片 Washer	06Cr17Ni12Mo2
5	螺母 Nut	A194-8M
6	开口销 Pin	06Cr17Ni12Mo2
7	销轴 Eyebolt Pin	06Cr17Ni12Mo2
8	支架 Yoke	ZG08Cr18Ni12MO2Ti
9	弹簧垫片 Spring gasket	06Cr17Ni12Mo2
10	螺栓 Bonnet Bolt	A194-8BM
11	铭牌 Nameplate	06Cr19Ni10
12	大薄片 Gasket	不锈钢+PTFE缠绕
13	阀盖 Bonnet	ZG08Cr18Ni12MO2Ti
14	吊环螺钉 Bolt	Steel
15	中法兰螺杆 Bonnet Bolt	A193-B8
16	中法兰螺母 Nut	A194-B8

执行标准 Compliance Standard

设计 Design	GB/T 12236
压力温度基准 Pressure-Temperature Rating	GB/T 12224
结构长度 Face to Face	GB/T 12221
法兰尺寸 Flange Dimensions	GB/T 9113.1
检验和测试 Inspection & Testing	JB/T 9092
主体材料 Body Material	GB/T12230-ZG08Cr18Ni9; ZG08Cr18Ni12Mo2Ti; ZG03Cr18Ni10; ZG12Cr18Ni12Mo2Ti; A216-WCB

主要尺寸 Dimensions

Unit:mm

公称压力 Nominal pressure	Size		Dimensions							
	DN	L	D(1)	D(2)	C	g	T	t	H	n-φ
PN1.6 Mpa	15	130	95	95	65	45	14	2	-	4-14
	20	150	105	105	75	55	14	2	-	4-14
	25	160	115	115	85	65	14	2	-	4-14
	32	180	135	135	100	78	16	2	-	4-18
	40	200	145	150	110	85	16	3	-	4-18
	50	230	160	165	125	100	16	3	160	4-18
	65	290	180	185	145	120	18	3	177	4-18
	80	310	195	200	160	135	20	3	187	8-18
	100	350	215	220	180	155	20	3	202	8-18
	125	400	245	250	210	185	22	3	227	8-18
	150	480	280	285	240	210	24	3	263	8-23
	200	550	335	340	295	265	26	3	293	12-23
	250	650	405	405	355	320	30	3	330	12-25
	300	750	460	460	410	375	30	4	392	12-25
	350	850	520	520	470	435	34	4	430	16-25
	400	950	580	580	525	485	36	4	480	16-30
500	1150	705	705	650	608	44	4	560	20-34	

主要尺寸 Dimensions

Unit:mm

公称压力 Nominal pressure	Size		Dimensions							
	DN	L	D(1)	D(2)	C	g	T	t	H	n-φ
PN2.5 Mpa	15	130	95	95	65	45	15	2	-	4-14
	20	150	105	105	75	55	15	2	-	4-14
	25	160	115	115	85	65	15	2	-	4-14
	32	180	135	135	100	78	15	2	-	4-18
	40	200	145	150	110	85	15	3	-	4-18
	50	230	160	165	125	100	20	3	177	4-18
	65	290	180	185	145	120	22	3	192	8-18
	80	310	195	200	160	135	22	3	192	8-18
	100	350	230	235	190	160	24	3	217	8-23
	125	400	270	275	220	188	25	3	250	8-25
	150	480	300	305	250	218	30	3	270	8-25
	200	550	360	365	310	278	34	3	350	12-25
	250	650	425	430	370	332	35	3	410	12-30
	300	750	485	490	430	390	40	4	430	16-30
	350	850	550	555	490	448	44	4	450	16-34
	400	950	610	615	550	505	45	4	560	16-34
500	1150	730	735	660	610	52	4	615	20-41	
PN4.0 Mpa	50	230	160	95	125	100	20	3	177	4-18
	65	290	180	105	145	120	22	3	192	8-18
	80	310	195	115	160	135	22	3	192	8-18
	100	350	230	140	190	160	24	3	217	8-23
	125	400	270	150	220	188	25	3	259	8-25
	150	480	300	165	250	218	30	3	270	8-25
	200	550	375	185	320	282	35	3	340	12-30
	250	650	445	200	385	345	42	3	407	12-34
	300	750	510	235	450	408	45	4	423	16-34
	350	850	570	270	510	465	52	4	450	16-34
	400	950	655	300	585	535	55	4	490	16-41
	500	1150	755	375	670	612	62	4	615	20-48

FLANGED SWING CHECK VALVE, ASME

主要构件材料 Materials of Main Construction

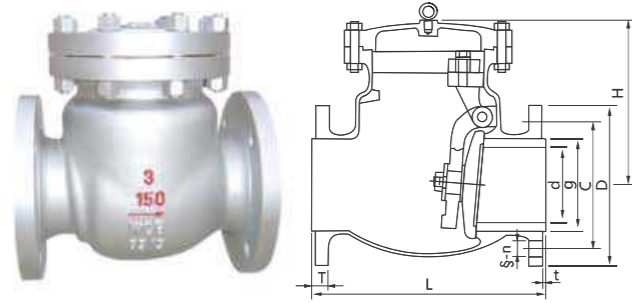

序号 No.	部件 Part Name	材料 Material
1	阀体 Body	A351-CF8M
2	阀瓣 Disc	A351-CF8M
3	螺母 Nut	A194-2H
4	垫片 Washer	SS304
5	摇杆 Hinge	A351-CF8M
6	销轴 Eyebolt Pin	SS316
7	中法兰螺母 Nut	A 194-2H
8	大薄片 Gasket	PTFE+304
9	阀盖 Bonnet	A351-CF8M
10	铭牌 Nameplate	Aluminum(铝)
11	中法兰螺杆 Bonnet Bolt	A193-B8
12	垫片 Washer	PTFE+304

执行标准 Compliance Standard

设计 Design	ASME B16.34
压力温度基准 Pressure-Temperature Rating	ASME B16.34
结构长度 Face to Face	ASME B16.10
法兰尺寸 Flange Dimensions	ASME B16.5
检验和测试 Inspection & Testing	API 598
主体材料 Body Material	A351-CF8; CF8M; CF3; CF3M; A216-WCB

主要尺寸 Dimensions

Unit:mm

公称压力 Nominal pressure	Size DN	Dimensions								
		d	L	D	C	g	T	t	H	n-φ
150#	1/2"	15	108	89	60.5	35	12	1.6	-	4-15
	3/4"	20	117	98	70	43	12	1.6	-	4-15
	1"	25	127	108	79.5	51	12	1.6	-	4-15
	1-1/4"	32	140	117	89	64	13	1.6	-	4-15
	1-1/2"	40	165	127	98.5	73	15	1.6	-	4-15
	2"	50	203	152	120.5	92	16	1.6	161	4-19
	2-1/2"	65	216	178	139.5	105	18	1.6	180	4-19
	3"	80	241	190	152.5	127	19	1.6	190	4-19
	4"	100	292	229	190.5	157	24	1.6	203	8-19
	5"	125	330	254	216	186	24	1.6	229	8-22
	6"	150	356	279	241.5	216	26	1.6	257	8-22
	8"	200	495	343	298.5	270	29	1.6	292	8-22
10"	250	622	406	362	324	31	1.6	355	12-25	
12"	300	698	483	432	381	32	1.6	396	12-25	

SPRING LOADED WAFER CHECK VALVE

执行标准 Compliance Standard

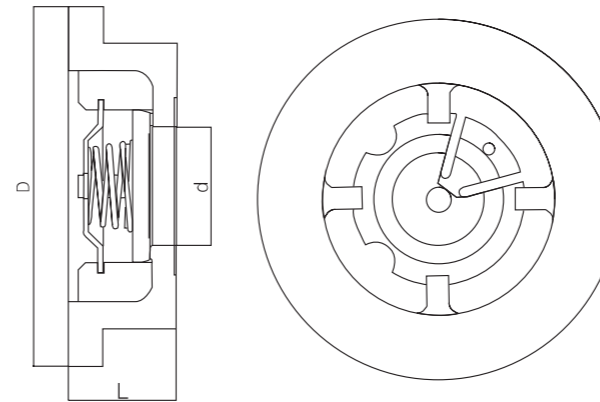

设计 Design	JB/T 8937
压力温度基准 Pressure-Temperature Rating	GB T 2224
结构长度 Face to Face	JB/T 8937
检验和测试 Inspection & Testing	JB/T 9092
主体材料 Body Material	304 CF8 CF8M

主要构件材料 Materials of Main Construction

序号 No.	部件 Part Name	材料 Material
1	阀体 Body	WC3/304/316
2	定位片 Lock plate	WC3/304/316
3	弹簧 Spring	WC3/304/316
4	阀瓣 Disc	WC3/304/316



主要尺寸 Dimensions

Unit:mm

公称压力 Nominal pressure	Size DN	Dimensions			
		d	L	D	
PN16~40	15	15	16	39	
	20	20	20	43	
	25	25	22	54	
	32	31	28	68	
	40	39	32	78	
	50	48	40	90	
	65	62	46	111	
	80	75	48	128	
	100	80	58	148	

DUAL-PLATE WAFER CHECK VALVE

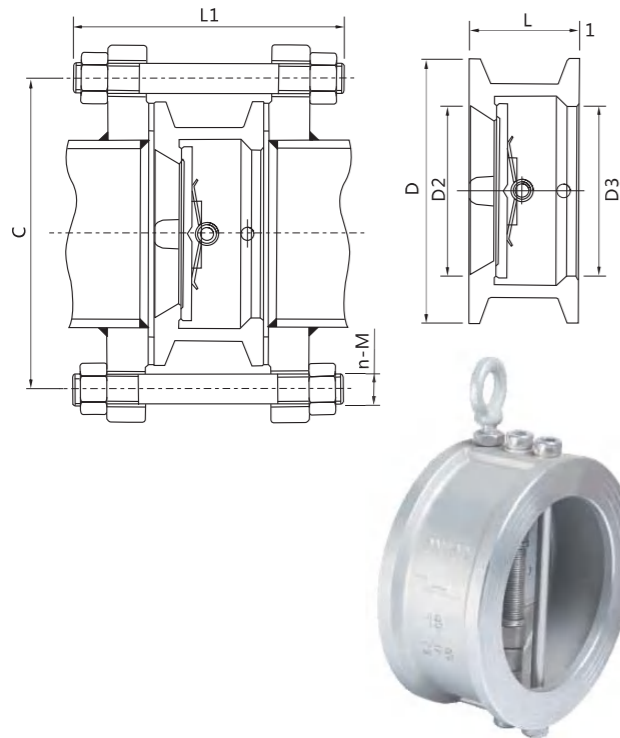

执行标准 Compliance Standard

设计 Design	API 594; JB/T 8937
压力温度基准 Pressure-Temperature Rating	ASME B16.34; GB/T 12224
结构长度 Face to Face	APL 594; JB/T 8937
检验和测试 Inspection & Testing	API 598
主体材料 Body Material	WCB CF8 CF8M

主要构件材料 Materials of Main Construction

序号 No.	部件 Part Name	材料 Material	
1	阀体 Body	CF8	WCB
2	阀瓣 Disc	CF8	WCB
3	弹簧 Spring	304	304
4	销轴 Eyebolt Pin	304	Steel
5	螺钉 Bolt	304	A193 B7

主要尺寸 Dimensions

Unit:mm

Size 压力级 Nominal pressure	口径 NPS	Dimensions								
		L	D	D2	D3	Flange dimension				
						C	n-in	n-M	L1	
Class 150LB	2"	60	103	51	56	120.5	4-5/8	4-16	145	
	2-1/2"	67	122	65	73	139.5	4-5/8	4-16	155	
	3"	73	135	80	88	152.5	4-5/8	4-16	165	
	4"	73	173	102	108	190.5	4-5/8	8-16	175	
	5"	86	195	127	132	216.5	8-3/4	8-20	195	
	6"	98	220	152	160	241.5	8-3/4	8-20	210	
	8"	127	277	203	210	298.5	8-3/4	8-20	245	
Class 300LB	10"	146	337	254	266	362.0	12-7/8	12-24	275	
	12"	181	407	305	310	342.0	12-7/8	12-24	315	
	2"	60	110	51	58	127	8-5/8	8-16	160	
	2-1/2"	67	128	65	73	149	8-3/4	8-20	180	
	3"	73	147	80	88	168.5	8-3/4	8-20	195	
	4"	73	179	102	108	200	8-3/4	8-20	200	
	5"	86	214	127	132	235	8-3/4	8-20	225	
Class 600LB	6"	98	249	152	160	270	12-3/4	12-20	240	
	8"	127	305	203	210	330	12-7/8	12-24	290	
	10"	146	359	254	266	387.5	16-1	16-27	320	
	12"	181	420	305	310	451	16-11/8	16-30	370	
	2"	60	110	51	58	127	8-5/8	8-16	180	
	2-1/2"	67	128	65	73	149	8-3/4	8-20	200	
	3"	73	147	80	88	168.5	8-3/4	8-20	215	
Class 600LB	4"	79	191	102	108	216	8-7/8	8-24	240	
	5"	105	239	127	136	267	8-1	8-27	285	
	6"	136	264	152	162	292	12-1	12-27	325	
	8"	165	318	200	212	349	12-11/8	12-30	375	
	10"	213	398	250	266	432	16-11/4	16-33	445	
	12"	229	455	305	312	489	20-11/4	20-33	465	

主要尺寸 Dimensions

Unit:mm

Size 公称压力 Nominal pressure	公称直径 Nomi.Dia DN	Dimensions						
		L	D	D2	D3	配管法兰(仅供参考)		
						C	n-M	L1
PN1.6 Mpa	50	60	109	51	56	125	4-16	150
	65	67	127	65	73	145	4-16	155
	80	73	144	82	88	160	8-16	160
	100	73	164	102	108	180	8-16	165
	125	86	194	127	132	210	8-16	180
	150	98	220	152	160	240	8-20	205
	200	127	275	203	210	295	12-20	235
PN2.5 Mpa	250	146	332	254	266	355	12-24	265
	300	181	387	305	310	410	12-24	305
	50	60	109	51	56	125	4-16	150
	65	67	129	65	73	145	8-16	160
	80	73	144	80	88	160	8-16	170
	100	73	168	102	108	190	8-20	180
	125	86	196	127	132	220	8-24	205
PN4.0 Mpa	150	98	224	152	160	250	8-24	220
	200	127	284	203	210	310	12-24	255
	250	146	341	254	266	370	12-27	285
	300	181	401	305	310	430	16-27	325
	50	60	109	51	58	125	4-16	150
	65	67	129	65	73	145	8-16	160
	80	73	144	80	88	160	8-16	170
PN4.0 Mpa	100	73	168	102	108	190	8-20	180
	125	86	196	127	132	220	8-24	205
	150	98	224	152	160	250	8-24	220
	200	127	291	203	210	320	12-27	270
	250	146	353	254	266	385	12-30	300
	300	181	418	305	310	450	16-30	345

Y-TYPE STRAINER
800WOG

PRODUCTS STANDARD

- ◆Investment Casting Body 精密铸造阀体
- ◆Pressure: 800# 压力等级
- ◆Design Acc 设计标准: ASME B16.34
- ◆Screw End Standard: DIN2999/BSP/NPT
ISO7-1/BS21
- ◆Inspection & Testing Acc 检测标准: API598
- ◆Screen Mesh: 40 Mesh or on option

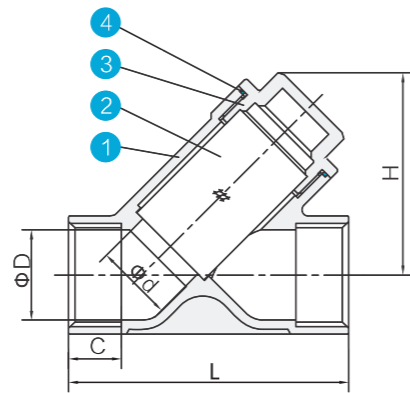

主要构件材料 Materials of Main Construction

Item No.	Part Name	Material
1	Body 阀体	CF8M / CF8 / WCB
2	Screen 滤网	SS316 / SS304
3	Cap 阀盖	CF8M / CF8 / WCB
4	Gasket 密封圈	PTFE

主要尺寸 Dimensions

Unit:mm

Size	1/4"	3/8"	1/2"	3/4"	1"	1-1/4"	1-1/2"	2"	2-1/2"	3"	4"
d	9	9	15	20	25	32	38	48	65	80	100
H	35	35	45	52	65	70	79.5	95.5	125.5	155	205
L	65	65	61	80	84	99	108	130	175	190	240

FLANGE Y TYPE STRAINER

PRODUCTS STANDARD

- ◆工作压力 Pressure of Work: 1.6MPa
- ◆试验压力 Test Pressure: 2.4MPa
- ◆工作温度 Working Temperature: -80~400℃
- ◆阀体Body: 铸铁、铸钢、不锈钢
Cast iron, cast steel, stainless steel
- ◆滤网 Mesh: 不锈钢 Stainless steel
- ◆法兰 Flange: ANSI 150#、300#、PN16、PN40、JIS、10K
- ◆材料 Material: WCB、304、316
- ◆规格 Size available: 1/2"-20"

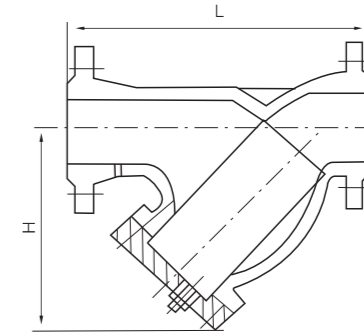

主要构件材料 Materials of Main Construction

Item No.	Part Name	Material
1	Body 阀体	WCB / 304 / 316
2	Mesh 滤网	304 / 304 / 316
3	Gasket 密封垫片	GRAPHITE / 304+GRAPHITE
4	Cap 阀盖	WCB / 304 / 316
5	Bolt	A193 B7 / 304 / 316

主要尺寸 Dimensions

Unit:mm

Size	1/2"	3/4"	1"	1-1/4"	1-1/2"	2"	2-1/2"	3"	4"	5"	6"	8"
L	150	150	160	180	200	220	255	280	310	340	390	490
H	70	70	80	90	100	110	130	170	210	230	260	350

STAINLESS STEEL CAMLOCK AND GROVED COUPLINGS SERIES

特点:

连接形式: 螺纹、法兰、焊接、卡套、快接
 材质为: SUS304、SUS316制成
 管道流量控制: DN15~150及1/2"-6"
 适用于各种条件及连接需要

Feature

Type: Screwed, flanged, welding, adjustable joint, quick coupling
 Material: SUS304, SUS316
 Size: DN15-150 and 1/2"-6"

TYPE:A ADAPTOR FEMALE

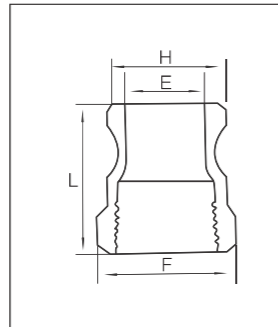

Size	1/2	3/4	1	1-1/4	2	2-1/2	3	4	6
E	14.3	21	23.8	30.8	46	58	73.2	98.2	149
F	29.3	39.2	43.8	51.9	74.7	82.3	97.8	126.8	191
H	24.3	32	36.6	45.5	63	75.9	91.5	119.5	175.9
L	41.3	39	48.5	52.5	61.7	68	70	74.6	86

TYPE:B COUPLER MALE

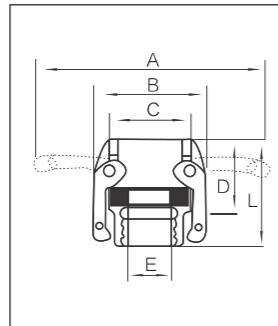

Size	1/2	3/4	1	1-1/4	1-1/2	2	2-1/2	3	4	6
A	68.4	116	125	181	189	199	210	254	282	409
B	39.9	53.3	60.9	82.6	90.3	99.8	112.4	137.6	166.6	255
C	34.9	41	47	58	65	75	90	108	140	198
D	32.5	32	39	44.5	45.0	50.0	54.3	55.5	55.5	73
E	14.3	19.0	25.0	36.6	39.0	50.8	63.0	76.2	100.8	146
L	49.2	51	58	67.2	65.7	75.4	83.3	86.5	88.8	116

TYPE:C COUPLER FEMALE

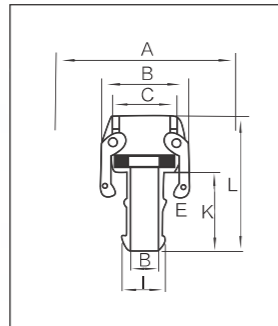

Size	1/2	3/4	1	1-1/4	1-1/2	2	2-1/2	3	4	6
A	68.4	116	125	181	189	199	210	254	282	409
B	39.9	53.3	60.9	82.6	90.3	99.8	112.4	137.6	166.6	255
C	34.9	41	47	58	65	75	91	108	140	198
E	8.0	13.8	19.8	25.9	32.3	44.5	56.7	68	93.4	142
I	14.6	21.0	27.0	33.7	40.1	52.7	66.3	79	104.4	157
K	41.3	51	57	59	61	70	79	102	108	146
L	84.9	82.8	95.2	102.5	104.0	129	142.3	157.1	163.5	214

TYPE:D 尺寸 COUPLER FEMALE

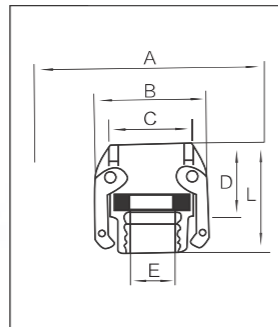

Size	1/2	3/4	1	1-1/4	1-1/2	2	2-1/2	3	4	6
A	68.4	116	125	181	189	199	210	254	282	409
B	39.9	53.3	60.9	82.6	90.3	99.8	112.4	137.6	166.6	255
C	34.9	41	47	58	65	75	91	108	140	198
D	32.5	32	39	44.5	45.0	50.0	54.3	55.5	55.5	74
E	14.3	21	25.0	34.9	39.0	50.8	63.0	76.2	100.8	146
L	49.2	51	61.0	67.5	67	72.2	83.3	86.5	88.8	114

STAINLESS STEEL CAMLOCK AND GROVED COUPLINGS SERIES

特点:

连接形式: 螺纹、法兰、焊接、卡套、快接
 材质为: SUS304、SUS316制成
 管道流量控制: DN15~150及1/2"-6"
 适用于各种条件及连接需要

Feature

Type: Screwed, flanged, welding, adjustable joint, quick coupling
 Material: SUS304, SUS316
 Size: DN15-150 and 1/2"-6"

TYPE:E ADAPTOR HSAE SHANK

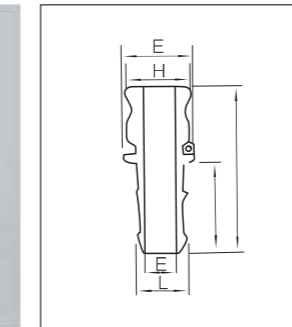

Size	1/2	3/4	1	1-1/4	1-1/2	2	2-1/2	3	4	5
E	8.0	13.8	19.8	25.9	32.3	44.5	56.7	68	93.4	142
H	24.3	32	36.6	45.5	53.4	63	75.9	91.5	119.5	175.9
I	14.6	21.0	27.0	33.7	40.1	52.7	66.3	79	104.4	157
J	30.2	35.0	38.0	45.0	55.4	65.3	79.5	93.5	121.5	187
K	41.3	51	60	57	60	70	80	100	108	146
L	86.5	86.3	105.9	109.5	113	138.5	149.5	166.6	174.5	224

TYPE:F ADAPTOR MALE

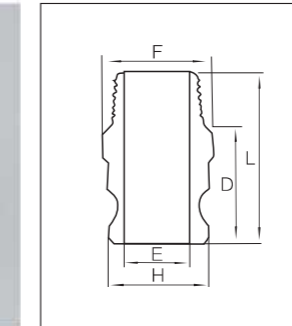

Size	1/2	3/4	1	1-1/4	1-1/2	2	2-1/2	3	4	5
D	34.1	39.0	48.5	52.5	54	61.7	68	70	74.5	83
E	14.3	21.3	23.8	30.8	38.5	46.7	58	73.2	93.2	149
F	29.3	39.2	43.8	51.9	60.4	74.7	82.3	97.8	126.8	196
H	24.3	32	36.6	45.5	53.4	63	75.9	91.5	119.5	175.9
L	48.8	58	67.5	73.2	74.7	87.1	79	101	107.9	127

TYPE:DC DUST CAP

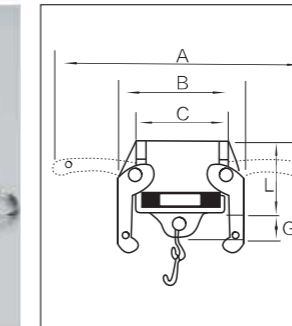

Size	1/2	3/4	1	1-1/4	1-1/2	2	2-1/2	3	4	5
A	68.4	116	125	181	189	199	210	254	282	409
B	39.9	53.3	60.9	82.6	90.3	99.8	112.4	137.6	166.6	255
C	34.9	41	47	58	65	75	90	108	140	198
G	9.5	10	12	11	12	12	14	15	12	16
L	32.5	34.0	41.0	46.5	53.2	53.2	57.8	59.5	60.0	68

TYPE:DP DUDST PLUG

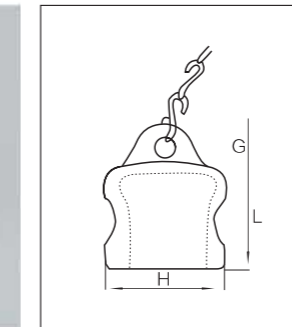

Size	1/2	3/4	1	1-1/4	1-1/2	2	2-1/2	3	4	5
G	9.5	12	13	12	16	19	11	11	12	16
H	24.3	32	36.5	45.5	53.4	63	75.9	91.5	119.5	175.9
L	26	27.5	36.5	42	44.0	50.8	53	55.0	52.3	60

SCREWED END FITTINGS

MATERIAL: 304 316

STANDARD: ISO4144



90° Elbow



Tee



Reduce Tee



Cross



45° Elbow



Street Elbow



Reduce Elbow



Union F/F



45° Elbow



Union SW



Reduce Banded



Soket Banded



Hexagon Bushing



Nipple



Hexagon Nipple



Reduce Hexagon Nipple



Hose Nipple



Barrel Nipple



Hose Nipple



Barrel Nipple

